

AERA 2" CYLINDER

WALL, WALL ASYMMETRIC
DIRECT/INDIRECT, DIRECT, INDIRECT

LUMENWERX



Project: _____

Type: _____

8" Height
Bevel



8" Height
Decorative Bevel



12" Height
Pinhole



True-to-size with a versatile minimalist aesthetic, Aera Cylinder luminaires are high-performance fixtures, delivering visually comfortable lighting suitable for a wide range of applications.

Beam Angles



Low UGR < 10 in 15°, 25°, 35°, and 50° beams

Performance

LUMEN OUTPUT ¹	WATTS	EFFICACY
552 lm	7 W	79 lm/W
727 lm	10 W	73 lm/W

¹Lumen packages are assuming 3500K, 80 CRI, 35° beam, bevel baffle, SDL lens option.

Light Source

Static White
Full Spectrum
SOLA - Dim-to-Warm
DUO - Tunable White



COB

2 Step Color Binning
Up to 95 CRI

Driver

1%, 0.1% Dimming Available
0-10V, TRIAC, ELV, Lutron EcoSystem, DALI, DMX
Emergency Battery (optional)

Distributions

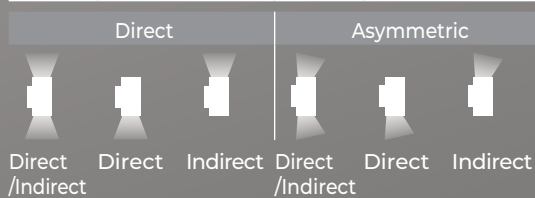

Mounting Options



Certification



Aera Family (Refer to other spec sheets)

Downlight



2" / 3" / 4" Round / Square Recessed Adjustable
2" / 3" / 4" Round / Square Recessed
2" / 3" / 4" Round / Square Recessed Wall Wash

Multi-aperture



2" / 3" / 4" Round / Square Recessed Adjustable
2" / 3" / 4" Round / Square Recessed
2" / 3" / 4" Round / Square Recessed Wall Wash

Cylinder

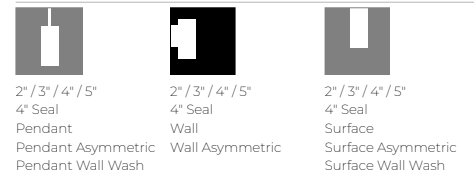

2" / 3" / 4" / 5" 4" Seal Pendant
2" / 3" / 4" / 5" 4" Seal Wall Asymmetric
2" / 3" / 4" / 5" 4" Seal Surface Asymmetric Surface Wall Wash



AERA 2" CYLINDER

WALL, WALL ASYMMETRIC
DIRECT/INDIRECT, DIRECT, INDIRECT

LUMENWERX

Project: _____

Type: _____



To specify a Title 24 JA8 compliant fixture, see page 3.

Order Guide

LUMINAIRE ID	DISTRIBUTION	CYLINDER HEIGHT ¹	CYLINDER FINISH	BAFFLE STYLE	BAFFLE FINISH
AE2CYW - Aera 2" Cylinder Wall AE2CYWASY - Aera 2" Cylinder Wall Asymmetric	DI - Direct/Indirect D - Direct I - Indirect	6IN ^{2,3} - 6" 8IN ² - 8" 12IN - 12"	FTMW - Textured matte white FTMB - Textured matte black FCHP - Champagne CF# - Custom finish, specify RAL#	BVL - Bevel PHL - Pinhole BVLD - Decorative bevel	FTMW - Textured matte white FTMB - Textured matte black FSPC - Specular FSSPC - Semi-specular FCHP - Champagne CF# - Custom finish, specify RAL#

¹For actual heights and minimum heights, see dimensions on page 4.
²For DI fixture, available with remote driver only.
³For Wall asymmetric with Direct or Indirect fixture, not available with integral driver.

LENS * See page 4 for details	LIGHT SOURCE	DIRECT BEAM Specify NA for Indirect	INDIRECT BEAM Specify NA for Direct	COLOR QUALITY	CRI	COLOR TEMP.	ACCESSORIES * See page 4 for details
At baffle (choose 1 option) Specify NOL for Pinhole SDL - Soft diffused lens, Solite FDL - Frosted diffused lens CL - Clear lens NOL - No lens	SW - Static white FS - Full spectrum SOLA - Dim-to-warm single channel control 35K to 22K DUO - Tunable white 2-channel control 65K to 27K	15DEG ⁴ - 15° Narrow spot 25DEG - 25° Spot 35DEG - 35° Narrow flood 50DEG - 50° Wide flood 80DEG ⁵ - 80° Very wide flood 90DEG ⁵ - 90° Open flood NA - Not applicable	15DEG ⁶ - 15° Narrow spot 25DEG - 25° Spot 35DEG - 35° Narrow flood 50DEG - 50° Wide flood 80DEG ⁷ - 80° Very wide flood 90DEG ⁷ - 90° Open flood NA - Not applicable	2STP ⁸ - 2 Step MacAdam Ellipse 3STP - 3 Step MacAdam Ellipse ⁸ Not available with full spectrum.	90CRI ⁹ - 90 CRI 95CRI - 95 CRI 80CRI ⁹ - 80 CRI ⁹ Not available with full spectrum.	27K - 2700K 30K - 3000K 35K - 3500K 40K - 4000K SOLA - Dim-to-warm single channel control 35K to 22K DUO - Tunable white 2-channel control 65K to 27K	At light element ^{10,11} (choose up to 2 options) LSDL - Soft diffused lens, Solite LFDL - Frosted diffused lens LS - Linear spread HEX - Hex louver NA - None ¹⁰ If two options are specified, separate codes with a "+", e.g. LSDL+HEX . ¹¹ LSDL and LFDL cannot be combined. LS and HEX cannot be combined.

* LSDL or LFDL at light element cannot be combined with SDL, FDL, or CL at baffle. For SOLA/DUO, one of the following lenses must be specified: SDL, FDL, LSDL, or LFDL.

VOLTAGE	DIRECT WATTAGE ¹³ Specify NA for Indirect		INDIRECT WATTAGE ¹⁵ Specify NA for Direct		DIMMING ¹⁸		
120V - 120V 277V - 277V UNV - 120V-277V 347V ¹² - 347V	WALL 7W - 7 W output, up to 560 lm 10W ¹⁴ - 10 W output, up to 736 lm NA - Not applicable	WALL ASY. 7W - 7 W output, up to 511 lm 10W ¹⁴ - 10 W output, up to 689 lm NA - Not applicable	WALL 7W - 7 W output, up to 560 lm 10W ¹⁶ - 10 W output, up to 736 lm NA - Not applicable	WALL ASY. 7W - 7 W output, up to 511 lm 10W ¹⁶ - 10 W output, up to 689 lm NA - Not applicable	INTEGRAL D1 - 1% 0-10V ELV ¹⁹ - ELV 120V TRI ¹⁹ - TRIAC 120V ¹⁸ PoE (Power-over-Ethernet) compatible. Consult factory for details. ¹⁹ Available with 120V only.	REMOTE ²⁰ RD1 - 1% 0-10V RELV ²¹ - ELV 120V RTRI ²¹ - TRIAC 120V ²⁰ A remote driver box is provided, see page 5 for details. ²¹ Available with 120V only.	RLDE1 ²² - Lutron Hi-lume 1% Eco RDA ²² - DALI RELD1 - eldoLED 1% ECOdrive 0-10V RELD0 - eldoLED 0.1% SOLOdrive 0-10V +EB ²³ - Emergency battery ²² On-site commissioning is required. ²³ For emergency battery, code will be like the following example: RD1+EB .
	SOLA 8W - 8 W output, up to 250 lm DUO 7W - 7 W output, up to 200 lm NA - Not applicable	SOLA 8W - 8 W output, up to 200 lm DUO 7W - 7 W output, up to 180 lm NA - Not applicable	SOLA ¹⁷ 8W - 8 W output, up to 250 lm DUO ¹⁷ 7W - 7 W output, up to 200 lm ¹⁷ For a Direct/Indirect fixture for SOLA/DUO, consult factory.	SOLA ¹⁷ 8W - 8 W output, up to 200 lm DUO ¹⁷ 7W - 7 W output, up to 180 lm ¹⁷ For a Direct/Indirect fixture for SOLA/DUO, consult factory.	SOLA SDI - Single 0-10V input SELV ¹⁹ - ELV 120V STRI ¹⁹ - TRIAC 120V	SOLA RSD1 - Single 0-10V input RSELV ²¹ - ELV 120V RSTRI ²¹ - TRIAC 120V	DUO RDMX ²² - DMX RDDA ²² - DALI DT6 RDDA8 ²² - DALI DT8 RDD1 - Dual 0-10V input for CCT/intensity RPSQ0 ²² - Lutron T-Series 1% tunable white

ELECTRICAL	MOUNTING TYPE	MOUNTING FINISH ²⁵	OPTION ²⁶
1C - 1 circuit 2C ²⁴ - 2 circuits ²⁴ Available with Direct/Indirect and remote driver only.	FLS - Flat square canopy, 4" octagonal junction box DM - Direct mount	FTMW - Textured matte white FTMB - Textured matte black FCHP - Champagne CF# - Custom finish, specify RAL# ²⁵ Direct wall mount finish matches cylinder finish.	NA - None ²⁶ To specify a JA8 compliant fixture, see page 3.



AERA 2" CYLINDER

WALL, WALL ASYMMETRIC
 DIRECT/INDIRECT, DIRECT, INDIRECT
 Title 24 JA8

LUMENWERX

Project: _____

Type: _____



Order Guide

LUMINAIRE ID	DISTRIBUTION	CYLINDER HEIGHT ¹	CYLINDER FINISH	BAFFLE STYLE	BAFFLE FINISH
AE2CYW - Aera 2" Cylinder Wall AE2CYWASY - Aera 2" Cylinder Wall Asymmetric	D - Direct I - Indirect	6IN ² - 6" 8IN - 8" 12IN - 12" ¹ For actual heights and minimum heights, see dimensions on page 4. ² For Wall asymmetric with Direct or Indirect fixture, not available with integral driver.	FTMW - Textured matte white FTMB - Textured matte black FCHP - Champagne CF# - Custom finish, specify RAL#	BVL - Bevel PHL - Pinhole BVLD - Decorative bevel	FTMW - Textured matte white FTMB - Textured matte black FSPC - Specular FSSPC - Semi-specular FCHP - Champagne CF# - Custom finish, specify RAL#

LENS * See page 4 for details	LIGHT SOURCE	DIRECT BEAM Specify NA for Indirect	INDIRECT BEAM Specify NA for Direct	COLOR QUALITY	CRI	COLOR TEMP.	ACCESSORY * See page 4 for details
					90CRI		
At baffle Specify NOL for Pinhole SDL - Soft diffused lens, Solite FDL - Frosted diffused lens CL - Clear lens NOL - No lens	SW - Static white SOLA - Dim-to-warm single channel control 35K to 22K	15DEG - 15° Narrow spot 25DEG - 25° Spot 35DEG - 35° Narrow flood 50DEG - 50° Wide flood 80DEG ³ - 80° Very wide flood 90DEG ³ - 90° Open flood NA - Not applicable ³ Not available with Asymmetric.	15DEG - 15° Narrow spot 25DEG - 25° Spot 35DEG - 35° Narrow flood 50DEG - 50° Wide flood 80DEG ⁴ - 80° Very wide flood 90DEG ⁴ - 90° Open flood NA - Not applicable ⁴ Not available with Asymmetric.	2STP - 2 Step MacAdam Ellipse 3STP - 3 Step MacAdam Ellipse 3STP - 3 Step MacAdam Ellipse	90CRI - 90 CRI	27K - 2700K 30K - 3000K 35K - 3500K 40K - 4000K SOLA - Dim-to-warm single channel control 35K to 22K	At light element LSDL - Soft diffused lens, Solite LFDL - Frosted diffused lens NA - None

* LSDL or LFDL at light element cannot be combined with SDL, FDL, or CL at baffle. For SOLA, one of the following lenses must be specified: SDL, FDL, LSDL, or LFDL.

VOLTAGE	DIRECT WATTAGE Specify NA for Indirect		INDIRECT WATTAGE Specify NA for Direct		DIMMING	
120V - 120V 277V - 277V	WALL 7W - 7 W output, up to 560 lm 8W - 8 W output, up to 250 lm NA - Not applicable	WALL ASY. 7W - 7 W output, up to 511 lm 8W - 8 W output, up to 200 lm NA - Not applicable	WALL 7W - 7 W output, up to 560 lm 8W - 8 W output, up to 250 lm NA - Not applicable	WALL ASY. 7W - 7 W output, up to 511 lm 8W - 8 W output, up to 200 lm NA - Not applicable	INTEGRAL DI - 1% 0-10V ELV ⁵ - ELV 120V TRI ⁵ - TRIAC 120V ⁵ Available with 120V only. SDI - Single 0-10V input SELV ⁵ - ELV 120V STRI ⁵ - TRIAC 120V	REMOTE ⁶ RD1 - 1% 0-10V RELV ⁷ - ELV 120V RTRI ⁷ - TRIAC 120V RLDE1 ⁸ - Lutron Hi-lume 1% Eco ⁶ A remote driver box is provided, see page 5 for details. ⁷ Available with 120V only. ⁸ On-site commissioning is required.

ELECTRICAL	MOUNTING TYPE	MOUNTING FINISH ⁹	OPTION
1C 1C - 1 circuit	FLS - Flat square canopy, 4" octagonal junction box DM - Direct mount	FTMW - Textured matte white FTMB - Textured matte black FCHP - Champagne CF# - Custom finish, specify RAL# ⁹ Direct mount finish matches cylinder finish.	JA8 JA8 - JA8 compliant



AERA 2" CYLINDER

LUMENWERX

WALL, WALL ASYMMETRIC
DIRECT/INDIRECT, DIRECT, INDIRECT

Overview

FLS
Flat square canopy,
4" octagonal junction box

DM
Direct mount

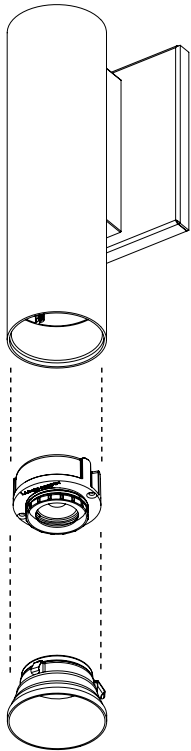

AE2CYW
Aera 2"
Cylinder
Wall

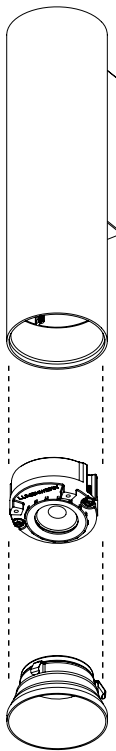

AE2CYWASY
Aera 2"
Cylinder
Wall
Asymmetric

LENS AND ACCESSORIES

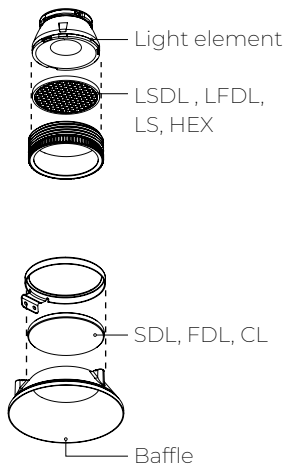

Dimensions

CYLINDER

Direct/Indirect ¹

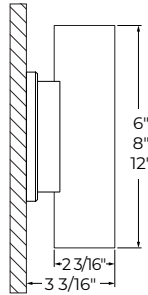

Direct ¹

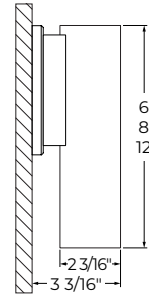

Indirect ¹

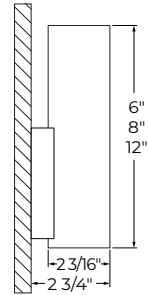

Flat square canopy ²

Flat square canopy ²

Direct mount ²

¹Certain restrictions apply. See page 2 for the height options available with integral and remote.

²Flat square canopy and direct mount options are available with all Direct/Indirect, Direct and Indirect.

Minimum heights - Cylinder

Size	Distribution	Direct		Asymmetric	
		Integral driver	Remote driver	Integral driver	Remote driver
Ø2"	Direct/Indirect	12"	6"	12"	6"
	Direct or Indirect	6"	6"	8"	6"

*Consult factory for maximum heights.

BAFFLE

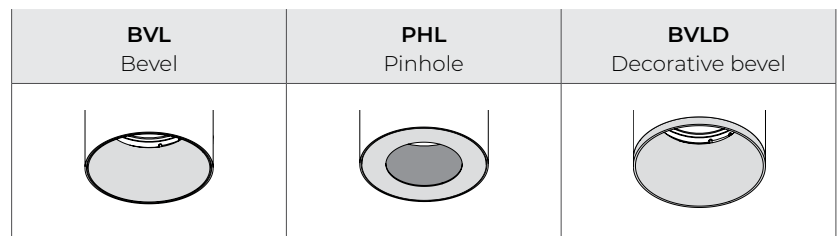

■ Baffle finish
■ Textured matte black

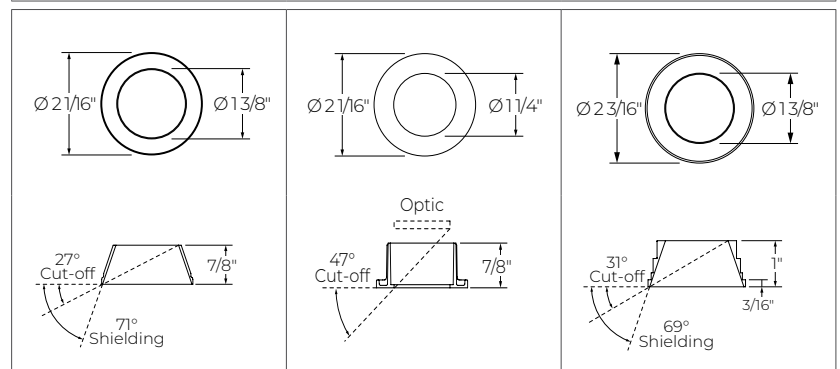

AERA 2" CYLINDER

LUMENWERX

WALL, WALL ASYMMETRIC
DIRECT/INDIRECT, DIRECT, INDIRECT

Mounting

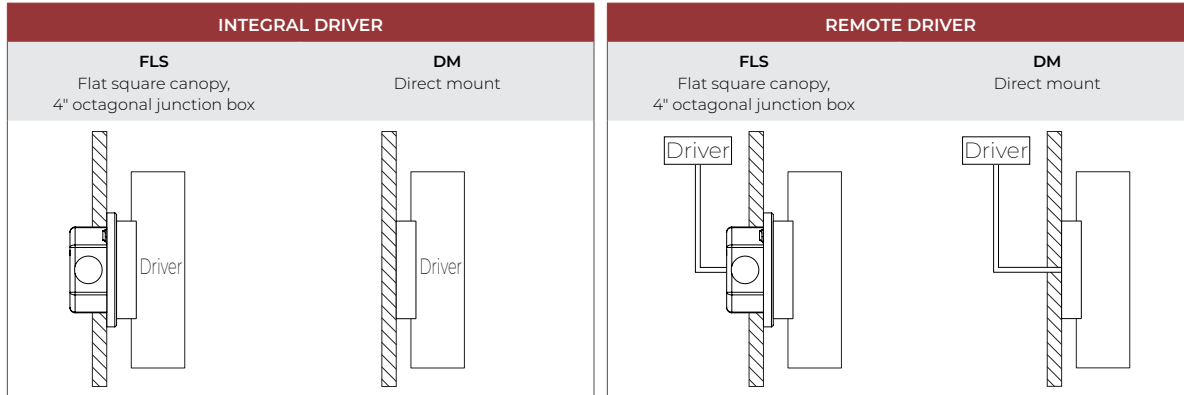

REMOTE DRIVER BOX

RDB8 / RDB18 / RDB24

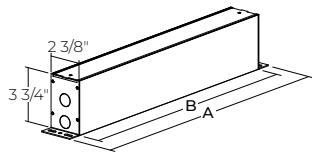

RDB24W

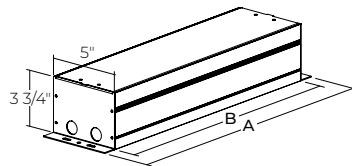

	RDB8	RDB18	RDB24	RDB24W
A	10"	20"	26"	26"
B	8"	18"	24"	24"
DRIVER	RD1 - 1% 0-10V RELV - ELV 120V RTRI - TRIAC 120V SOLA RSD1 - Single 0-10V input RSELV - ELV 120V RSTRI - TRIAC 120V	RLDE1 - Lutron Hi-lume 1% Eco RDA - DALI RELD1 - eldoLED 1% ECOdrive 0-10V RELD0 - eldoLED 0.1% SOLOdrive 0-10V	Emergency battery (+EB) with the following driver options. RD1+EB - 1% 0-10V RELV+EB - ELV 120V RTRI+EB - TRIAC 120V DUO RDMX - DMX RDDA - DALI DT6 RDDA8 - DALI DT8 RDD1 - Dual 0-10V input for CCT/intensity RPSQO - Lutron T-Series 1% tunable white	Emergency battery (+EB) with the following driver options. RLDE1+EB - Lutron Hi-lume 1% Eco RDA+EB - DALI RELD1+EB - eldoLED 1% ECOdrive 0-10V RELD0+EB - eldoLED 0.1% SOLOdrive 0-10V

AERA 2" CYLINDER

LUMENWERX

WALL, WALL ASYMMETRIC

DIRECT/INDIRECT, DIRECT, INDIRECT

Color Quality

COLOR QUALITY - 3500K

TM-30 R _r	91
TM-30 R _g	100
CRI	90
R9	> 50

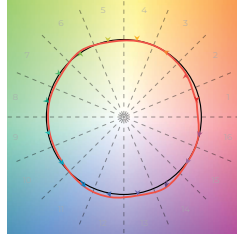

Photometrics

Please follow the multiplier tables to ensure correct lumen value. Beams, CCT, baffle styles, baffle colors, lensing and accessories will change the lumen value. Performance values apply to both Direct and Indirect.

WALL

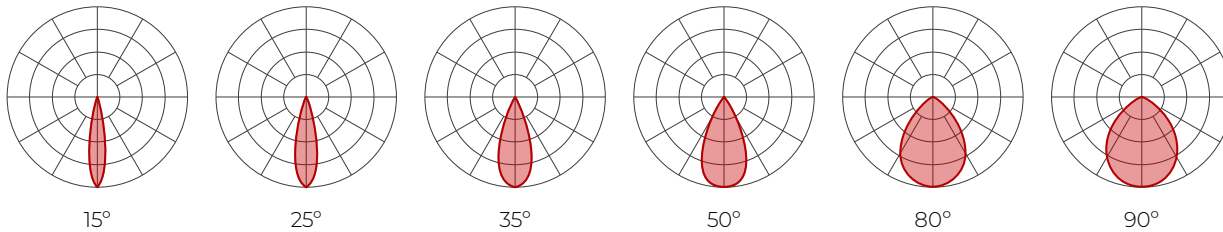

Delivered Lumens for Bevel Baffles - At 35K, with SDL lens option

CRI	90 CRI						95 CRI						80 CRI					
	15	25	35	50	80	90	15	25	35	50	80	90	15	25	35	50	80	90
7 W	479	523	516	495	446	446	369	403	397	381	343	343	513	560	552	530	477	477
10 W	629	688	679	651	586	586	484	530	523	501	451	451	673	736	727	697	627	627

Efficacy Based on Delivered Lumens

CRI	90 CRI						95 CRI						80 CRI					
	15	25	35	50	80	90	15	25	35	50	80	90	15	25	35	50	80	90
7 W	68	75	74	71	64	64	53	58	57	54	49	49	73	80	79	76	68	68
10 W	63	69	68	65	59	59	48	53	52	50	45	45	67	74	73	70	63	63

MULTIPLIERS

CCT	BAFFLE STYLE AND COLOR			LENS * (At baffle)		ACCESSORIES * (At light element)		
	2700K	0.9	Bevel	White	1	SDL - Soft diffused lens, Solite	1	LSDL - Soft diffused lens, Solite
3000K	0.95		Black	1	FDL - Frosted lens	0.8	LFDL - Frosted lens	0.8
3500K	1	Pinhole	White	0.92	CL - Clear lens	1.1	LS - Linear spread	0.84
4000K	1.05		Black	0.92	NOL - No lens	1.1	HEX - Hex louver	0.86
For SOLA and DUO, please consult factory.		Decorative bevel	White	1	* When more than one lens or accessory is specified, multiply together the value of each lens and/or accessory. e.g. NOL + LSDL + HEX = 1.1 x 1 x 0.86 = 0.946			
			Black	1				

DIRECT/INDIRECT - EFFICACY CALCULATION

For Direct/Indirect performance values, follow the formula.

$$\frac{\left(\begin{matrix} \text{DIRECT} \\ \text{DELIVERED LM} \end{matrix} + \begin{matrix} \text{INDIRECT} \\ \text{DELIVERED LM} \end{matrix} \right)}{\left(\begin{matrix} \text{DIRECT} \\ \text{WATTAGE} \end{matrix} + \begin{matrix} \text{INDIRECT} \\ \text{WATTAGE} \end{matrix} \right)} = \text{EFFICACY}$$

AERA 2" CYLINDER

LUMENWERX

WALL, WALL ASYMMETRIC

DIRECT/INDIRECT, DIRECT, INDIRECT

Please follow the multiplier tables to ensure correct lumen value. Beams, CCT, baffle styles, baffle colors, lensing and accessories will change the lumen value. Performance values apply to both Direct and Indirect.

WALL ASYMMETRIC

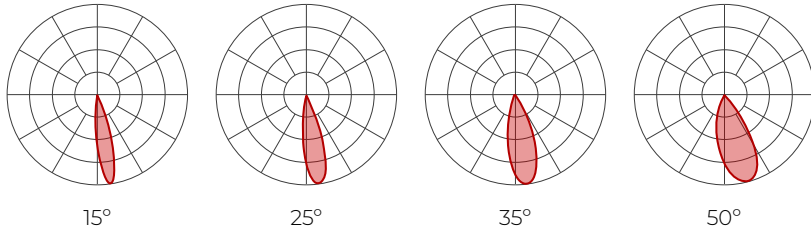

Delivered Lumens for Bevel Baffles - At 35K, with SDL lens option

CRI	90 CRI				95 CRI				80 CRI			
	15	25	35	50	15	25	35	50	15	25	35	50
7 W	445	461	478	410	343	355	368	316	476	493	511	439
10 W	599	621	644	552	461	478	496	425	641	664	689	591

Efficacy Based on Delivered Lumens

CRI	90 CRI				95 CRI				80 CRI			
	15	25	35	50	15	25	35	50	15	25	35	50
7 W	64	66	68	59	49	51	53	45	68	70	73	63
10 W	60	62	64	55	46	48	50	43	64	66	69	59

MULTIPLIERS

CCT		BAFFLE STYLE AND COLOR		LENS * (At baffle)		ACCESSORIES * (At light element)		
2700K	0.9	Bevel	White	1	SDL - Soft diffused lens, Solite	1	LSDL - Soft diffused lens, Solite	1
3000K	0.95		Black	1	FDL - Frosted lens	0.8	LFDL - Frosted lens	0.8
3500K	1	Pinhole	White	0.92	CL - Clear lens	1.1	LS - Linear spread	0.84
4000K	1.05		Black	0.92	NOL - No lens	1.1	HEX - Hex louver	0.86
		Decorative bevel	White	1	* When more than one lens or accessory is specified, multiply together the value of each lens and/or accessory. e.g. NOL + LSDL + HEX = 1.1 x 1 x 0.86 = 0.946			
			Black	1				

For SOLA and DUO, please consult factory.

DIRECT/INDIRECT - EFFICACY CALCULATION

For Direct/Indirect performance values, follow the formula.

$$\frac{\left(\begin{array}{c} \text{DIRECT} \\ \text{DELIVERED LM} \end{array} + \begin{array}{c} \text{INDIRECT} \\ \text{DELIVERED LM} \end{array} \right)}{\left(\begin{array}{c} \text{DIRECT} \\ \text{WATTAGE} \end{array} + \begin{array}{c} \text{INDIRECT} \\ \text{WATTAGE} \end{array} \right)} = \text{EFFICACY}$$

AERA 2" CYLINDER

WALL, WALL ASYMMETRIC
DIRECT/INDIRECT, DIRECT, INDIRECT

LUMENWERX

Technical Specifications

OPTIC

XPoint™ Refraction Technology optics provide precise optical control in a remarkably compact form. Micro optical paths from the chip on board converge and then disperse in precise beam angles, resulting in a crisp and exacting light quality.

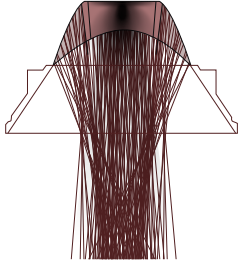

LIGHT SOURCE

Compact COB (Chip-On-Board) LED module, available in 2700K, 3000K, 3500K and 4000K with a choice of 80 CRI, 90 CRI, or 95 CRI, with elevated R9 value for 90 CRI and above. Color consistency is maintained to within 2 SDCM. All LEDs have been tested in accordance with IESNA LM-80-08 and the results have shown L80 lumen maintenance greater than 60,000 hours. Absolute product photometry is measured and presented in accordance with IESNA LM-79, unless otherwise indicated. Optional full spectrum LEDs can be incorporated in the fixture to increase Cyanosis Observation Index (COI) and assist in regulating circadian rhythms.

CHROMAWERX

Chromawerx SOLA

Chromawerx SOLA is single-channel control that dims output while warming the color temperature in a pre-determined relationship. A simple analog control adjusts a specially populated LED array to emulate the effect of dimming a filament source.

Chromawerx DUO

Chromawerx DUO offers a two-channel control system which uses analog or digital protocols for synchronous control of both cool (6500K) to warm (2700K) LED arrays - maintaining a CRI above 90. The range of color DUO offers is useful for entraining circadian rhythms, stimulating alertness, and compensating for jet lag among other applications. The Chromawerx drivers are programmed to limit maximum light output and power usage across all color temperatures. When paired with DALI drivers (DDA/DDA8), color tuning follows a linear dimming curve.

ELECTRICAL

Unless otherwise specified, dimming down to 1%. At maximum driver load: efficiency>84%, PF>0.9, THD<20%.

Integral: 0-10V, ELV, TRIAC.

Remote: 0-10V, ELV, TRIAC, Lutron Hi-Lume 1% EcoSystem, DALI, eldoLED 0.1% SOLOdrive 0-10V, eldoLED 1% ECOdrive 0-10V, DMX, Lutron T-series (tunable white).

Emergency Battery Option: Remotely-installed, long-life, high-temperature, maintenance-free, Bodine Lithium-Ion battery pack with self-test functionality, test switch and charge indicator. IOTA and Fulham options available upon request. Minimum of 90 minutes operation, and recharge time of 24 hours. For fixtures less than 10W, the battery provides 6W of emergency light output. For fixtures 10W and over, the battery provides 10W.

PoE

Depending on the PoE manufacturer selected, Lumenwerx will install the node in factory as either integral to the luminaire, or as a remote module. Factory programming of the PoE node may or may not enable the following functionalities: lumen package, Duo (tunable white), emergency battery backup, and sensor integration. These must be addressed and evaluated on a case-by-case basis.

CONSTRUCTION

Housing: Extruded aluminum

Canopy: Flat and direct

Arm: Machined aluminum

Finish: Textured matte white, black, and champagne. Custom colors also available (provide RAL #). Specular and semi-specular finishes are also available for Baffle.

Heat sink: Die-cast aluminum.

WEIGHT

Direct/Indirect	Direct or Indirect
6" - 1 lbs - 0.5 kg	8" - 1.2 lbs - 0.6 kg
12" - 1.8 lbs - 0.8 kg	12" - 1.5 lbs - 0.7 kg

AERA 2" CYLINDER

LUMENWERX

WALL, WALL ASYMMETRIC
DIRECT/INDIRECT, DIRECT, INDIRECT

BAFFLE

Die-cast aluminum

Baffle style: Bevel, pinhole, and decorative bevel

LENS AND ACCESSORIES



Soft diffused lens, Solite



Frosted diffused lens



Clear lens



Linear Spread



Hex Louver

ENVIRONMENT

Ambient temperature at fixture location shall be within 0°C/32°F - 25°C/77°F, indoor dry or damp as well as outdoor damp use (canopies or marquees).

CERTIFICATIONS

ETL - Rated for Indoor Dry/Damp locations. Conforms to UL Standard 1598 and certified to CAN/CSA Standard C22.2 No. 250.0.

Title 24 JA8 - California Building Standards Code

WARRANTY

Lumenwerx provides a five-year limited warranty of electrical and mechanical performance of the luminaires, including the LED boards, drivers, and auxiliary electronics. Lumenwerx will repair or replace defective luminaires or components at our discretion, provided they have been installed and operated in accordance with our specifications. Other limitations apply, please refer to the full warranty on our website.