

AERA 4" CYLINDER

WALL, WALL ASYMMETRIC
DIRECT/INDIRECT, DIRECT, INDIRECT



Project: _____
Type: _____

LUMENWERX

8" Height
Bevel



8" Height
Decorative Bevel



12" Height
Pinhole

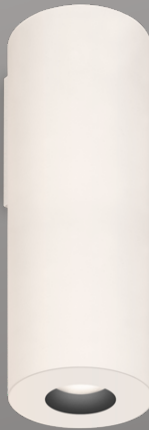

True-to-size with a versatile minimalist aesthetic, Aera Cylinder luminaires are high-performance fixtures, delivering visually comfortable lighting suitable for a wide range of applications.

Beam Angles



Low UGR < 10 in 15°, 25°, 35°, and 50° beams

Performance

LUMEN OUTPUT ¹	WATTS	EFFICACY
1481 lm	14 W	106 lm/W
2066 lm	20 W	103 lm/W
2775 lm	28 W	99 lm/W

¹Lumen packages are assuming 3500K, 80 CRI, 35° beam, bevel baffle, SDL lens option.

Distributions

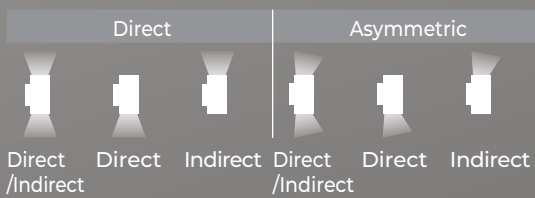

Mounting Options



Certification



Light Source

Static White
Full Spectrum
SOLA - Dim-to-Warm
DUO - Tunable White



COB

2 Step Color Binning
Up to 95 CRI

Driver

1%, 0.1% Dimming Available
0-10V, TRIAC, ELV, Lutron EcoSystem, DALI, DMX
Emergency Battery (optional)

Aera Family (Refer to other spec sheets)

Downlight



2" / 3" / 4"
Round / Square
Recessed Adjustable



2" / 3" / 4"
Round / Square
Recessed



2" / 3" / 4"
Round / Square
Recessed Wall Wash

Multi-aperture



2" / 3" / 4"
Round / Square
Recessed Adjustable



2" / 3" / 4"
Round / Square
Recessed



2" / 3" / 4"
Round / Square
Recessed Wall Wash

Cylinder



2" / 3" / 4" / 5"
4" Seal
Pendant

Pendant Asymmetric
Pendant Wall Wash



2" / 3" / 4" / 5"
4" Seal
Wall

Wall Asymmetric



2" / 3" / 4" / 5"
4" Seal
Surface

Surface Asymmetric
Surface Wall Wash

www.lumenwerx.com
T (514) 225-4304

© Lumenwerx, ULC. All rights reserved.



Lumenwerx reserves the right to modify product specifications without notification.
AERA4-CYLINDER-WALL-SPEC-REV4 July 4, 2023



AERA 4" CYLINDER

WALL, WALL ASYMMETRIC
DIRECT/INDIRECT, DIRECT, INDIRECT

LUMENWERX

Project: _____

Type: _____

Order Guide



To specify a Title 24 JA8 compliant fixture, see page 3.

LUMINAIRE ID	DISTRIBUTION	CYLINDER HEIGHT ¹		CYLINDER FINISH	BAFFLE STYLE	BAFFLE FINISH
AE4CYW - Aera 4" Cylinder Wall AE4CYWASY - Aera 4" Cylinder Wall Asymmetric	DI - Direct/Indirect D - Direct I - Indirect	DIRECT/INDIRECT	DIRECT OR INDIRECT	FTMW - Textured matte white FTMB - Textured matte black FCHP - Champagne CF# - Custom finish, specify RAL#	BVL - Bevel PHL - Pinhole BVLD - Decorative bevel	FTMW - Textured matte white FTMB - Textured matte black FSSPC - Semi-specular FCHP - Champagne CF# - Custom finish, specify RAL#
		8IN ² - 8" 12IN ² - 12" 14IN - 14"	6IN ² - 6" 8IN - 8" 12IN - 12" 14IN - 14"			
		¹ For minimum heights, see dimensions on page 4. ² Available with remote driver only.				

LENS * See page 4 for details	LIGHT SOURCE	DIRECT BEAM Specify NA for Indirect	INDIRECT BEAM Specify NA for Direct	COLOR QUALITY	CRI	COLOR TEMP.	ACCESSORIES * See page 4 for details
At baffle (choose 1 option) Specify NOL for Pinhole SDL - Soft diffused lens, Solite FDL - Frosted diffused lens CL - Clear lens NOL - No lens	SW - Static white FS - Full spectrum SOLA - Dim-to-warm single channel control 35K to 22K DUO - Tunable white 2-channel control 65K to 27K	15DEG - 15° Narrow spot 25DEG - 25° Spot 35DEG - 35° Narrow flood 50DEG - 50° Wide flood 80DEG ³ - 80° Very wide flood 90DEG ³ - 90° Open flood NA - Not applicable	15DEG - 15° Narrow spot 25DEG - 25° Spot 35DEG - 35° Narrow flood 50DEG - 50° Wide flood 80DEG ⁴ - 80° Very wide flood 90DEG ⁴ - 90° Open flood NA - Not applicable	2STP ⁵ - 2 Step MacAdam Ellipse 3STP - 3 Step MacAdam Ellipse ⁵ Not available with full spectrum.	90CRI ⁶ - 90 CRI 95CRI - 95 CRI 80CRI ⁶ - 80 CRI ⁶ Not available with full spectrum.	27K - 2700K 30K - 3000K 35K - 3500K 40K - 4000K SOLA - Dim-to-warm single channel control 35K to 22K DUO - Tunable white 2-channel control 65K to 27K	At light element ^{7,8} (choose up to 2 options) LSDL - Soft diffused lens, Solite LFDL - Frosted diffused lens LS - Linear spread HEX - Hex louver NA - None
				³ Not available with Asymmetric. 50DEG - 50° Wide flood NA - Not applicable	⁴ Not available with Asymmetric. 50DEG - 50° Wide flood NA - Not applicable	3STP - 3 Step MacAdam Ellipse	90CRI - 90 CRI

* LSDL or LFDL at light element cannot be combined with SDL, FDL, or CL at baffle. For SOLA/DUO, one of the following lenses must be specified: SDL, FDL, LSDL, or LFDL.

VOLTAGE	DIRECT WATTAGE ¹⁰ Specify NA for Indirect		INDIRECT WATTAGE ¹³ Specify NA for Direct		DIMMING ¹⁶									
120V - 120V 277V - 277V UNV - 120V-277V 347V ⁹ - 347V ⁹ Available with RD1 driver only. Please consult factory.	WALL 14W - 14 W output, up to 1538 lm 20W - 20 W output, up to 2146 lm 28W ^{11,12} - 28 W output, up to 2882 lm NA - Not applicable	WALL ASY. 14W - 14 W output, up to 1119 lm 20W - 20 W output, up to 1782 lm 28W ^{11,12} - 28 W output, up to 2393 lm NA - Not applicable	WALL 14W - 14 W output, up to 1538 lm 20W - 20 W output, up to 2146 lm 28W ^{14,15} - 28 W output, up to 2882 lm NA - Not applicable	WALL ASY. 14W - 14 W output, up to 1119 lm 20W - 20 W output, up to 1782 lm 28W ^{14,15} - 28 W output, up to 2393 lm NA - Not applicable	INTEGRAL D1 - 1% 0-10V ELV ¹⁷ - ELV 120V TRI ¹⁷ - TRIAC 120V ¹⁶ PoE (Power-over-Ethernet) compatible. Consult factory for details. ¹⁷ Available with 120V only.	REMOTE ¹⁸ RD1 - 1% 0-10V RELV ¹⁹ - ELV 120V RTRI ¹⁹ - TRIAC 120V ¹⁸ A remote driver box is provided, see page 5 for details. ¹⁹ Available with 120V only.	RLDE1 ²⁰ - Lutron Hi-lume 1% Eco RDA ²⁰ - DALI RELD1 - eldoLED 1% ECOdrive 0-10V RELD0 - eldoLED 0.1% SOLOdrive 0-10V +EB ²¹ - Emergency battery ²⁰ On-site commissioning is required. ²¹ For emergency battery, code will be like the following example: RD1+EB .							
								¹⁰ Lumen outputs are reduced with full spectrum, consult factory. ¹¹ Not available for a Direct/Indirect fixture. ¹² Not available with full spectrum.		¹³ Lumen outputs are reduced with full spectrum, consult factory. ¹⁴ Not available for a Direct/Indirect fixture. ¹⁵ Not available with full spectrum.				
								SOLA 25W - 25 W output, up to 1400 lm DUO 19W - 19 W output, up to 1100 lm	SOLA 25W - 25 W output, up to 1100 lm DUO 19W - 19 W output, up to 900 lm	SOLA 25W - 25 W output, up to 1400 lm DUO 19W - 19 W output, up to 1100 lm	SOLA 25W - 25 W output, up to 1100 lm DUO 19W - 19 W output, up to 900 lm	SOLA SD1 - Single 0-10V input SELV ¹⁷ - ELV 120V STRI ¹⁷ - TRIAC 120V	SOLA RSD1 - Single 0-10V input RSELV ¹⁹ - ELV 120V RSTRI ¹⁹ - TRIAC 120V	DUO RD1 - DMX RDDA ²⁰ - DALI DT6 RDDA8 ²⁰ - DALI DT8 RDD1 - Dual 0-10V input for CCT/intensity RPSQ0 ²⁰ - Lutron T-Series 1% tunable white
								NA - Not applicable		NA - Not applicable				

ELECTRICAL	MOUNTING TYPE	MOUNTING FINISH ²³	OPTION ²⁴
1C - 1 circuit 2C ²² - 2 circuits ²² Available with Direct/Indirect and remote driver only.	FLS - Flat square canopy, 4" octagonal junction box DM - Direct mount	FTMW - Textured matte white FTMB - Textured matte black FCHP - Champagne CF# - Custom finish, specify RAL# ²³ Direct mount finish matches cylinder finish.	NA - None ²⁴ To specify a JA8 compliant fixture, see page 3.



AERA 4" CYLINDER

WALL, WALL ASYMMETRIC
 DIRECT/INDIRECT, DIRECT, INDIRECT
 Title 24 JA8

LUMENWERX

Project: _____

Type: _____



Order Guide

LUMINAIRE ID	DISTRIBUTION	CYLINDER HEIGHT ¹	CYLINDER FINISH	BAFFLE STYLE	BAFFLE FINISH
AE4CYW - Aera 4" Cylinder Wall AE4CYWASY - Aera 4" Cylinder Wall Asymmetric	D - Direct I - Indirect	6IN ² - 6" 8IN - 8" 12IN - 12" 14IN - 14" ¹ For minimum heights, see dimensions on page 4. ² Available with remote driver only.	FTMW - Textured matte white FTMB - Textured matte black FCHP - Champagne CF# - Custom finish, specify RAL#	BVL - Bevel PHL - Pinhole BVLD - Decorative bevel	FTMW - Textured matte white FTMB - Textured matte black FSPC - Specular FSSPC - Semi-specular FCHP - Champagne CF# - Custom finish, specify RAL#

LENS * See page 4 for details	LIGHT SOURCE	DIRECT BEAM Specify NA for Indirect	INDIRECT BEAM Specify NA for Direct	COLOR QUALITY	CRI	COLOR TEMP.	ACCESSORY * See page 4 for details
	SW				90CRI		
At baffle Specify NOL for Pinhole SDL - Soft diffused lens, Solite FDL - Frosted diffused lens CL - Clear lens NOL - No lens	SW - Static white	15DEG - 15° Narrow spot 25DEG - 25° Spot 35DEG - 35° Narrow flood 50DEG - 50° Wide flood 80DEG ³ - 80° Very wide flood 90DEG ³ - 90° Open flood NA - Not applicable ³ Not available with Asymmetric.	15DEG - 15° Narrow spot 25DEG - 25° Spot 35DEG - 35° Narrow flood 50DEG - 50° Wide flood 80DEG ⁴ - 80° Very wide flood 90DEG ⁴ - 90° Open flood NA - Not applicable ⁴ Not available with Asymmetric.	2STP - 2 Step MacAdam Ellipse 3STP - 3 Step MacAdam Ellipse	90CRI - 90 CRI	27K - 2700K 30K - 3000K 35K - 3500K 40K - 4000K	At light element LSDL - Soft diffused lens, Solite LFDL - Frosted diffused lens NA - None

* **LSDL** or **LFDL** at light element cannot be combined with **SDL**, **FDL**, or **CL** at baffle.

VOLTAGE	DIRECT WATTAGE Specify NA for Indirect		INDIRECT WATTAGE Specify NA for Direct		DIMMING	
120V - 120V 277V - 277V UNV - 120V-277V	WALL 14W - 14 W output, up to 1538 lm NA - Not applicable	WALL ASY. 14W - 14 W output, up to 1119 lm NA - Not applicable	WALL 14W - 14 W output, up to 1538 lm NA - Not applicable	WALL ASY. 14W - 14 W output, up to 1119 lm NA - Not applicable	INTEGRAL D1 - 1% 0-10V ELV ⁵ - ELV 120V TRI ⁵ - TRIAC 120V ⁵ Available with 120V only.	REMOTE ⁶ RD1 - 1% 0-10V RELV ⁷ - ELV 120V RTRI ⁷ - TRIAC 120V RLDE1 ⁸ - Lutron Hi-lume 1% Eco ⁶ A remote driver box is provided, see page 5 for details. ⁷ Available with 120V only. ⁸ On-site commissioning is required.

ELECTRICAL	MOUNTING TYPE	MOUNTING FINISH ⁹	OPTION
1C			JA8
1C - 1 circuit	FLS - Flat square canopy, 4" octagonal junction box DM - Direct mount	FTMW - Textured matte white FTMB - Textured matte black FCHP - Champagne CF# - Custom finish, specify RAL# ⁹ Direct mount finish matches cylinder finish.	JA8 - JA8 compliant



AERA 4" CYLINDER

LUMENWERX

WALL, WALL ASYMMETRIC

DIRECT/INDIRECT, DIRECT, INDIRECT

Overview

FLS
Flat square canopy,
4" octagonal junction box

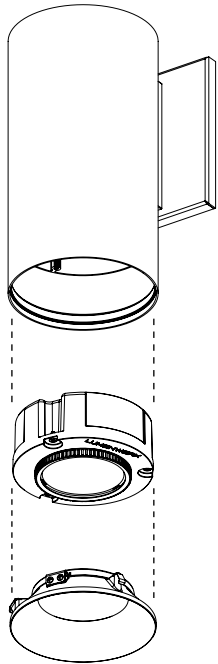

AE4CYW
Aera 4"
Cylinder
Wall

DM
Direct mount

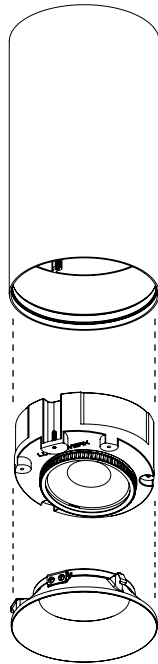

AE4CYWASY
Aera 4"
Cylinder
Wall
Asymmetric

LENS AND ACCESSORIES

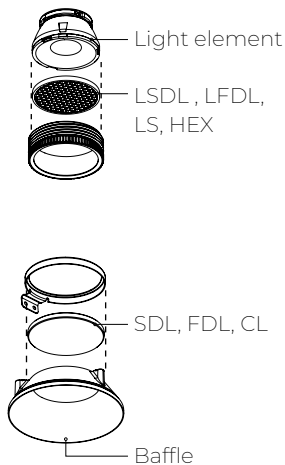

Dimensions

CYLINDER

Direct/Indirect¹

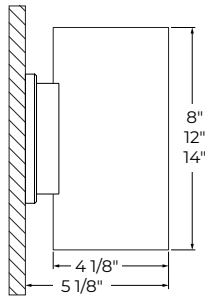

Flat square canopy²

Direct¹

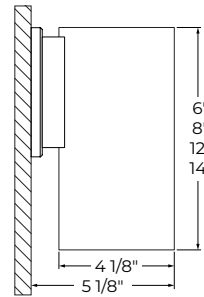

Flat square canopy²

Indirect¹

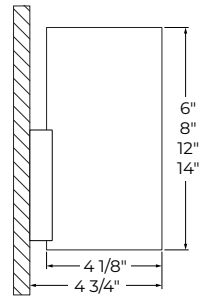

Direct mount²

¹Certain restrictions apply. See page 2 for the height options available with integral and remote.

²Flat square canopy and direct mount options are available with all Direct/Indirect, Direct and Indirect.

Minimum heights - Cylinder

Size	Distribution	Direct		Asymmetric	
		Integral driver	Remote driver	Integral driver	Remote driver
Ø4"	Direct/Indirect	14"	8"	14"	8"
	Direct or Indirect	8"	6"	8"	6"

^{*}Consult factory for maximum heights.

BAFFLE

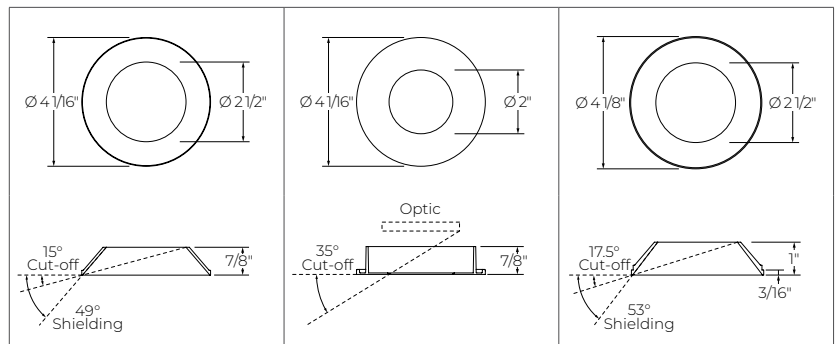
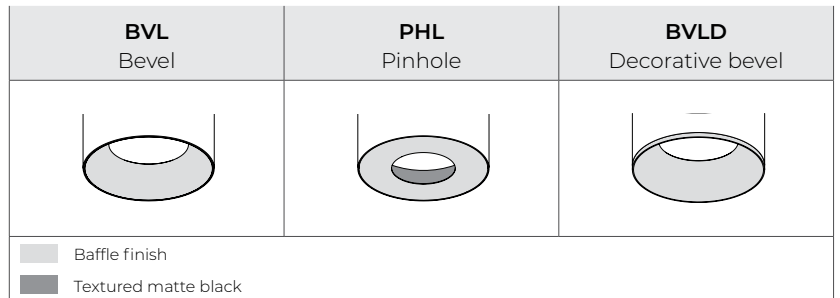

AERA 4" CYLINDER

LUMENWERX

WALL, WALL ASYMMETRIC
DIRECT/INDIRECT, DIRECT, INDIRECT

Mounting

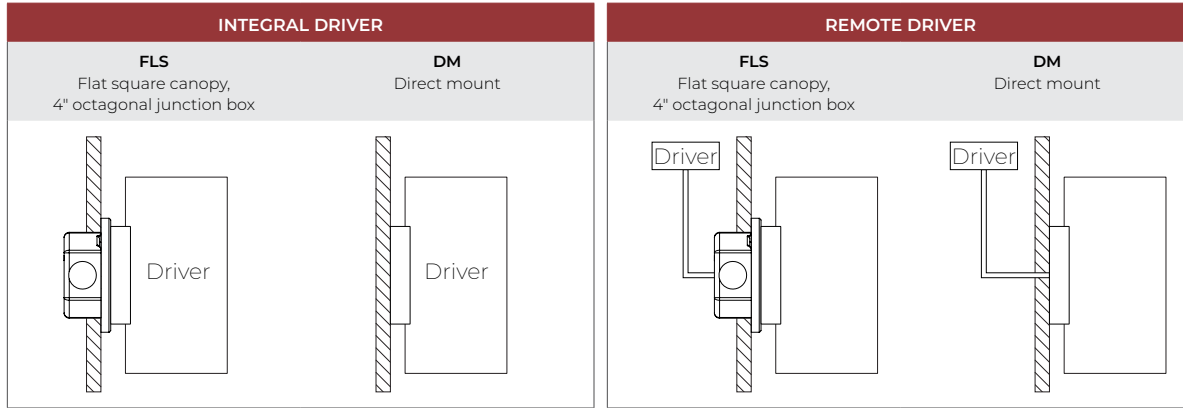

REMOTE DRIVER BOX

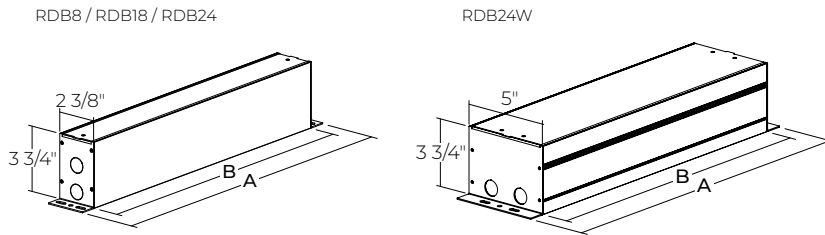

	RDB8	RDB18	RDB24	RDB24W
A	10"	20"	26"	26"
B	8"	18"	24"	24"
DRIVER	RD1 - 1% 0-10V RELV - ELV 120V RTRI - TRIAC 120V SOLA RSD1 - Single 0-10V input RSELV - ELV 120V RSTRI - TRIAC 120V	RLDE1 - Lutron Hi-lume 1% Eco RDA - DALI RELD1 - eldoLED 1% ECOdrive 0-10V RELD0 - eldoLED 0.1% SOLOdrive 0-10V	Emergency battery (+EB) with the following driver options. RD1+EB - 1% 0-10V RELV+EB - ELV 120V RTRI+EB - TRIAC 120V DUO RDMX - DMX RDDA - DALI DT6 RDDA8 - DALI DT8 RDD1 - Dual 0-10V input for CCT/intensity RPSQ0 - Lutron T-Series 1% tunable white	Emergency battery (+EB) with the following driver options. RLDE1+EB - Lutron Hi-lume 1% Eco RDA+EB - DALI RELD1+EB - eldoLED 1% ECOdrive 0-10V RELD0+EB - eldoLED 0.1% SOLOdrive 0-10V

AERA 4" CYLINDER

LUMENWERX

WALL, WALL ASYMMETRIC

DIRECT/INDIRECT, DIRECT, INDIRECT

Color Quality

COLOR QUALITY - 3500K

TM-30 Rr	90
TM-30 Ra	100
CRI	90
R9	> 50

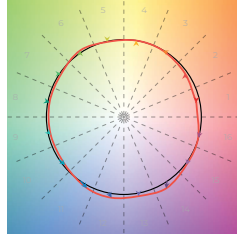

Photometrics

Please follow the multiplier tables to ensure correct lumen value. Beams, CCT, baffle styles, baffle colors, lensing and accessories will change the lumen value. Performance values apply to both Direct and Indirect.

WALL

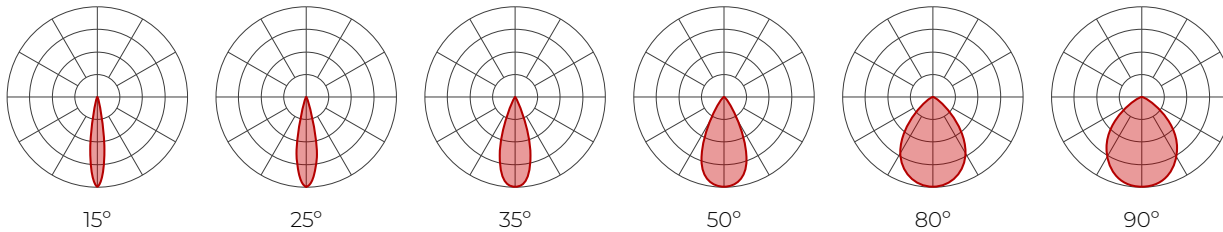

Delivered Lumens for Bevel Baffles - At 35K, with SDL lens option

CRI	90 CRI						95 CRI						80 CRI					
	15	25	35	50	80	90	15	25	35	50	80	90	15	25	35	50	80	90
BEAM																		
14 W	1399	1437	1384	1356	1220	1220	1077	1106	1066	1044	940	940	1497	1538	1481	1451	1306	1306
20 W	1952	2006	1931	1893	1704	1704	1503	1545	1487	1458	1312	1312	2089	2146	2066	2026	1823	1823
28 W	2621	2693	2593	2541	2287	2287	2018	2074	1997	1957	1761	1761	2804	2882	2775	2719	2447	2447

Efficacy Based on Delivered Lumens

CRI	90 CRI						95 CRI						80 CRI					
	15	25	35	50	80	90	15	25	35	50	80	90	15	25	35	50	80	90
BEAM																		
14 W	100	103	99	97	87	87	77	79	76	75	67	67	107	110	106	104	93	93
20 W	98	100	97	95	85	85	75	77	74	73	66	66	104	107	103	101	91	91
28 W	94	96	93	91	82	82	72	74	71	70	63	63	100	103	99	97	87	87

MULTIPLIERS

CCT	BAFFLE STYLE AND COLOR			LENS * (At baffle)		ACCESSORIES * (At light element)		
	2700K	0.9	Bevel	White	1	SDL - Soft diffused lens, Solite	1	LSDL - Soft diffused lens, Solite
3000K	0.95		Black	1	FDL - Frosted lens	0.8	LFDL - Frosted lens	0.8
3500K	1	Pinhole	White	0.92	CL - Clear lens	1.1	LS - Linear spread	0.84
4000K	1.05		Black	0.92	NOL - No lens	1.1	HEX - Hex louver	0.86
For SOLA and DUO, please consult factory.		Decorative bevel	White	1	* When more than one lens or accessory is specified, multiply together the value of each lens and/or accessory. e.g. NOL + LSDL + HEX = 1.1 x 1 x 0.86 = 0.946			
		Black	1					

DIRECT/INDIRECT - EFFICACY CALCULATION

For Direct/Indirect performance values, follow the formula.

$$\frac{\left(\begin{matrix} \text{DIRECT} \\ \text{DELIVERED LM} \end{matrix} + \begin{matrix} \text{INDIRECT} \\ \text{DELIVERED LM} \end{matrix} \right)}{\left(\begin{matrix} \text{DIRECT} \\ \text{WATTAGE} \end{matrix} + \begin{matrix} \text{INDIRECT} \\ \text{WATTAGE} \end{matrix} \right)} = \text{EFFICACY}$$

AERA 4" CYLINDER

LUMENWERX

WALL, WALL ASYMMETRIC

DIRECT/INDIRECT, DIRECT, INDIRECT

Please follow the multiplier tables to ensure correct lumen value. Beams, CCT, baffle styles, baffle colors, lensing and accessories will change the lumen value. Performance values apply to both Direct and Indirect.

WALL ASYMMETRIC

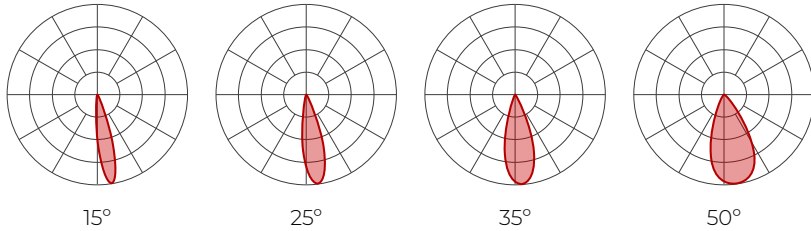

Delivered Lumens for Bevel Baffles - At 35K, with SDL lens option

CRI	90 CRI				95 CRI				80 CRI			
	15	25	35	50	15	25	35	50	15	25	35	50
14 W	977	1025	1018	1046	752	789	784	805	1045	1097	1089	1119
20 W	1556	1632	1621	1665	1198	1257	1248	1282	1665	1746	1734	1782
28 W	2089	2191	2176	2236	1609	1687	1676	1722	2235	2344	2328	2393

Efficacy Based on Delivered Lumens

CRI	90 CRI				95 CRI				80 CRI			
	15	25	35	50	15	25	35	50	15	25	35	50
14 W	70	73	73	75	54	56	56	58	75	78	78	80
20 W	78	82	81	83	60	63	62	64	83	87	87	89
28 W	75	78	78	80	57	60	60	61	80	84	83	85

MULTIPLIERS

CCT		BAFFLE STYLE AND COLOR			LENS * (At baffle)		ACCESSORIES * (At light element)	
2700K	0.9	Bevel	White	1	SDL - Soft diffused lens, Solite	1	LSDL - Soft diffused lens, Solite	1
3000K	0.95		Black	1	FDL - Frosted lens	0.8	LFDL - Frosted lens	0.8
3500K	1	Pinhole	White	0.92	CL - Clear lens	1.1	LS - Linear spread	0.84
			Black	0.92	NOL - No lens	1.1	HEX - Hex louver	0.86
4000K	1.05	Decorative bevel	White	1	* When more than one lens or accessory is specified, multiply together the value of each lens and/or accessory. e.g. NOL + LSDL + HEX = 1.1 x 1 x 0.86 = 0.946			
			Black	1				

For SOLA and DUO, please consult factory.

DIRECT/INDIRECT - EFFICACY CALCULATION

For Direct/Indirect performance values, follow the formula.

$$\frac{\left(\begin{array}{c} \text{DIRECT} \\ \text{DELIVERED LM} \end{array} + \begin{array}{c} \text{INDIRECT} \\ \text{DELIVERED LM} \end{array} \right)}{\left(\begin{array}{c} \text{DIRECT} \\ \text{WATTAGE} \end{array} + \begin{array}{c} \text{INDIRECT} \\ \text{WATTAGE} \end{array} \right)} = \text{EFFICACY}$$

AERA 4" CYLINDER

WALL, WALL ASYMMETRIC
DIRECT/INDIRECT, DIRECT, INDIRECT

LUMENWERX

Technical Specifications

OPTIC

XPoint™ Refraction Technology optics provide precise optical control in a remarkably compact form. Micro optical paths from the chip on board converge and then disperse in precise beam angles, resulting in a crisp and exacting light quality.

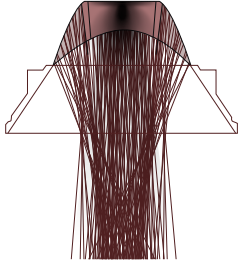

LIGHT SOURCE

Compact COB (Chip-On-Board) LED module, available in 2700K, 3000K, 3500K and 4000K with a choice of 80 CRI, 90 CRI, or 95 CRI, with elevated R9 value for 90 CRI and above. Color consistency is maintained to within 2 SDCM. All LEDs have been tested in accordance with IESNA LM-80-08 and the results have shown L80 lumen maintenance greater than 60,000 hours. Absolute product photometry is measured and presented in accordance with IESNA LM-79, unless otherwise indicated. Optional full spectrum LEDs can be incorporated in the fixture to increase Cyanosis Observation Index (COI) and assist in regulating circadian rhythms.

CHROMAWERX

Chromawerx SOLA

Chromawerx SOLA is single-channel control that dims output while warming the color temperature in a pre-determined relationship. A simple analog control adjusts a specially populated LED array to emulate the effect of dimming a filament source.

Chromawerx DUO

Chromawerx DUO offers a two-channel control system which uses analog or digital protocols for synchronous control of both cool (6500K) to warm (2700K) LED arrays - maintaining a CRI above 90. The range of color DUO offers is useful for entraining circadian rhythms, stimulating alertness, and compensating for jet lag among other applications. The Chromawerx drivers are programmed to limit maximum light output and power usage across all color temperatures. When paired with DALI drivers (DDA/DDA8), color tuning follows a linear dimming curve.

ELECTRICAL

Unless otherwise specified, dimming down to 1%. At maximum driver load: efficiency>84%, PF>0.9, THD<20%.

Integral: 0-10V, ELV, TRIAC.

Remote: 0-10V, ELV, TRIAC, Lutron Hi-Lume 1% EcoSystem, DALI, eldoLED 0.1% SOLOdrive 0-10V, eldoLED 1% ECOdrive 0-10V, DMX, Lutron T-series (tunable white).

Emergency Battery Option: Remotely-installed, long-life, high-temperature, maintenance-free, Bodine Lithium-Ion battery pack with self-test functionality, test switch and charge indicator. IOTA and Fulham options available upon request. Minimum of 90 minutes operation, and recharge time of 24 hours. For fixtures less than 10W, the battery provides 6W of emergency light output. For fixtures 10W and over, the battery provides 10W.

PoE

Depending on the PoE manufacturer selected, Lumenwerx will install the node in factory as either integral to the luminaire, or as a remote module. Factory programming of the PoE node may or may not enable the following functionalities: lumen package, Duo (tunable white), emergency battery backup, and sensor integration. These must be addressed and evaluated on a case-by-case basis.

CONSTRUCTION

Housing: Extruded aluminum

Canopy: Flat and direct

Arm: Machined aluminum

Finish: Textured matte white, black, and champagne. Custom colors also available (provide RAL #). Specular and semi-specular finishes are also available for Baffle.

Heat sink: Die-cast aluminum.

WEIGHT

Direct/Indirect	Direct or Indirect
8" - 3.5 lbs - 1.6 kg	6" - 2.3 lbs - 1 kg
14" - 5 lbs - 2.3 kg	8" - 2.9 lbs - 1.3 kg
	12" - 3.4 lbs - 1.5 kg

AERA 4" CYLINDER

LUMENWERX

WALL, WALL ASYMMETRIC
DIRECT/INDIRECT, DIRECT, INDIRECT

BAFFLE

Die-cast aluminum

Baffle style: Bevel, pinhole, and decorative bevel

LENS AND ACCESSORIES



Soft diffused
lens, Solite



Frosted
diffused lens



Clear lens



Linear Spread



Hex Louver

ENVIRONMENT

Ambient temperature at fixture location shall be within 0°C/32°F - 25°C/77°F, indoor dry or damp as well as outdoor damp use (canopies or marquees).

CERTIFICATIONS

ETL - Rated for Indoor Dry/Damp locations. Conforms to UL Standard 1598 and certified to CAN/CSA Standard C22.2 No. 250.0.

Title 24 JA8 - California Building Standards Code

WARRANTY

Lumenwerx provides a five-year limited warranty of electrical and mechanical performance of the luminaires, including the LED boards, drivers, and auxiliary electronics. Lumenwerx will repair or replace defective luminaires or components at our discretion, provided they have been installed and operated in accordance with our specifications. Other limitations apply, please refer to the full warranty on our website.