

FLAIR 3" DIFFUSER

CYLINDER WALL

DIRECT/INDIRECT, DIRECT, INDIRECT



6" Height

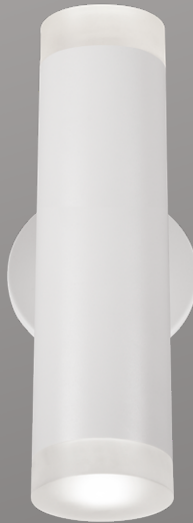

8" Height

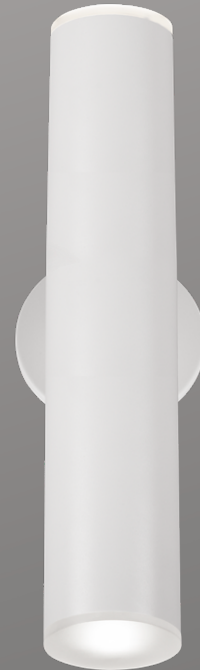

12" Height

The Flair Cylinder family is a series of pendant, surface, and wall mounted decorative luminaires featuring refined proportions, attention to detail, and minimalist versatility. It consists of the Flair Sleeve, Flair Diffuser, and Flair Glow Ring. The Flair Diffuser is available in 2" or 3" diameters, while the Flair Sleeve and Flair Glow Ring are available in 3" diameters only.

Direct optic - Diffuser



Fully frosted
1/4" diffuser



Fully frosted
3/4" diffuser



Partially frosted
3/4" diffuser

Indirect optic - Diffuser



Fully frosted
1/4" diffuser



Fully frosted
3/4" diffuser



Partially frosted
3/4" diffuser

Flair Cylinder Family (Refer to other spec sheets)



2" / 3"
Diffuser



3"
Glow ring



3"
Sleeve

Pendant/Surface/Wall Pendant/Surface/Wall Pendant/Surface/Wall

www.lumenwerx.com
T (514) 225-4304

© Lumenwerx, ULC. All rights reserved.



Lumenwerx reserves the right to modify product specifications without notification.

FLAIR3-DIFFUSER-CYLINDER-WALL-SPEC-REV2 July 29, 2024



FLAIR 3" DIFFUSER

CYLINDER WALL

DIRECT/INDIRECT, DIRECT, INDIRECT



Project: _____

Type: _____

Order Guide

LUMINAIRE ID	DISTRIBUTION	CYLINDER HEIGHT	CYLINDER FINISH	OPTIC
FL3DFCYW				
FL3DFCYW - Flair 3" Diffuser Cylinder Wall	DI - Direct/Indirect D - Direct I - Indirect	6IN ¹ - 6" 8IN ¹ - 8" 12IN - 12" ¹ For Direct/Indirect fixture, available with remote driver only.	FTMW - Textured matte white FTMB - Textured matte black FCHP - Champagne CF# - Custom finish, specify RAL#	FF14 - Fully frosted 1/4" diffuser FF34 - Fully frosted 3/4" diffuser PF34 - Partially frosted 3/4" diffuser

LIGHT SOURCE	COLOR QUALITY	CRI	COLOR TEMP.	VOLTAGE
SW - Static white FS - Full spectrum	2STP ² - 2 Step MacAdam Ellipse 3STP - 3 Step MacAdam Ellipse ² Not available with full spectrum.	90CRI ³ - 90 CRI 95CRI - 95 CRI 80CRI ³ - 80 CRI ³ Not available with full spectrum.	27K - 2700K 30K - 3000K 35K - 3500K 40K - 4000K	120V - 120V 277V - 277V UNV - 120V-277V 347V ⁴ - 347V ⁴ Available with RD1 driver only. Please consult factory.
SOLA - Dim-to-warm single channel control 35K to 22K DUO - Tunable white 2-channel control 65K to 27K	3STP - 3 Step MacAdam Ellipse	90CRI - 90 CRI	SOLA - Dim-to-warm single channel control 35K to 22K DUO - Tunable white 2-channel control 65K to 27K	

DIRECT WATTAGE ⁵ Specify NA for Indirect	INDIRECT WATTAGE ⁷ Specify NA for Direct	DIMMING ⁹	
		INTEGRAL	REMOTE¹¹
10W - 10 W output, up to 742 lm 14W - 14 W output, up to 1007 lm 20W ⁶ - 20 W output, up to 1383 lm NA - Not applicable ⁵ Lumen outputs are reduced with full spectrum, consult factory. ⁶ Not available for a Direct/Indirect fixture.	10W - 10 W output, up to 742 lm 14W - 14 W output, up to 1007 lm 20W ⁸ - 20 W output, up to 1383 lm NA - Not applicable ⁷ Lumen outputs are reduced with full spectrum, consult factory. ⁸ Not available for a Direct/Indirect fixture.	DI - 1% 0-10V ELV ¹⁰ - ELV 120V TRI ¹⁰ - TRIAC 120V ⁹ PoE (Power-over-Ethernet) compatible. Consult factory for details. ¹⁰ Available with 120V only.	RD1 - 1% 0-10V RELV ¹² - ELV 120V RTRI ¹² - TRIAC 120V RLDE1 ¹³ - Lutron Hi-lume 1% Eco RDA ¹⁵ - DALI RELD1 - eldoLED 1% ECOdrive 0-10V RELD0 - eldoLED 0.1% SOLOdrive 0-10V +EB ¹⁴ - Emergency battery ¹¹ A remote driver box is provided, see page 4 for details. ¹² Available with 120V only. ¹³ On-site commissioning is required. ¹⁴ For emergency battery, code will be like the following example: RD1+EB.
SOLA 12W - 12 W output, up to 615 lm DUO 11W - 11 W output, up to 450 lm NA - Not applicable	SOLA 12W - 12 W output, up to 615 lm DUO 11W - 11 W output, up to 450 lm NA - Not applicable	SOLA SD1 - Single 0-10V input SELV ¹⁰ - ELV 120V STRI ¹⁰ - TRIAC 120V	SOLA RSD1 - Single 0-10V input RSELV ¹² - ELV 120V RSTRI ¹² - TRIAC 120V DUO RDMX ¹⁵ - DMX RDDA ¹⁵ - DALI DT6 RDDA8 ¹⁵ - DALI DT8 RDD1 - Dual 0-10V input for CCT/intensity RLD2 ¹⁵ - Lutron DALI-2 digital

ELECTRICAL	MOUNTING TYPE	MOUNTING FINISH ¹⁶
1C - 1 circuit 2C ¹⁵ - 2 circuits ¹⁵ Available with Direct/Indirect and remote driver only.	FLR - Flat round canopy, 4" octagonal junction box DM - Direct mount	FTMW - Textured matte white FTMB - Textured matte black FCHP - Champagne CF# - Custom finish, specify RAL# ¹⁶ Direct mount finish matches cylinder finish.

FLAIR 3" DIFFUSER

CYLINDER WALL

DIRECT/INDIRECT, DIRECT, INDIRECT



Dimensions

CYLINDER

Direct/Indirect ¹

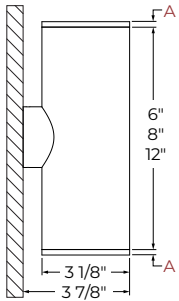

Direct mount ²

Direct ¹

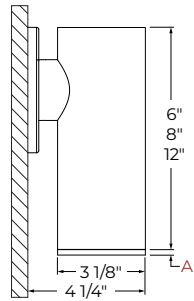

Flat round canopy ²

Indirect ¹

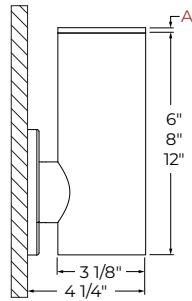

Flat round canopy ²

DIFFUSER	A
Fully frosted 1/4"	1/4"
Fully frosted 3/4"	3/4"
Partially frosted 3/4"	3/4"

¹Certain restrictions apply. See page 2 for the height options available with integral and remote.

²Flat round canopy and direct mount options are available with all Direct/Indirect, Direct and Indirect.

OPTIC - DIFFUSER

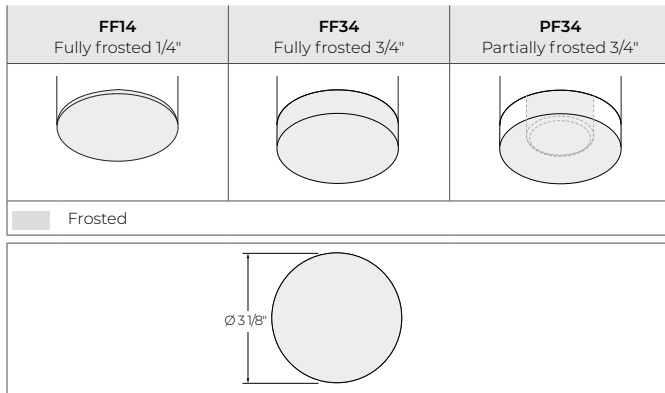

FLAIR 3" DIFFUSER



CYLINDER WALL

DIRECT/INDIRECT, DIRECT, INDIRECT

Mounting

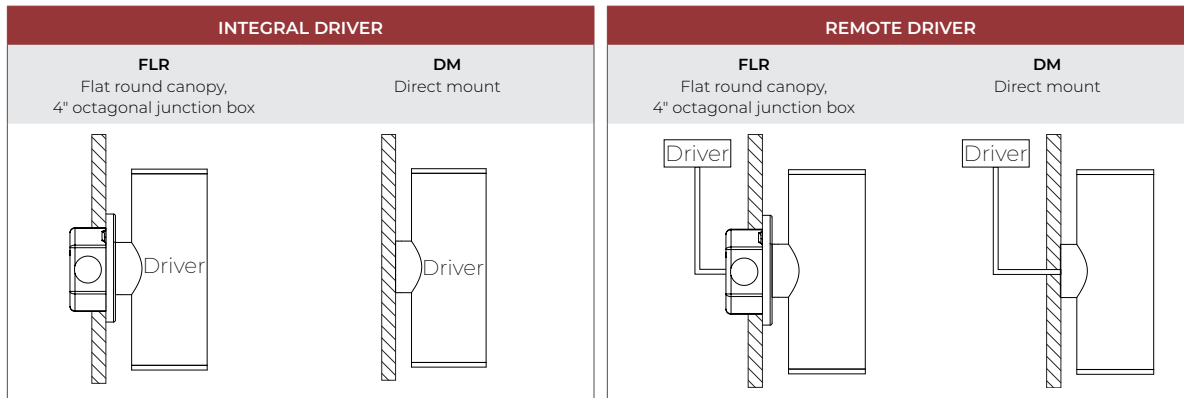

REMOTE DRIVER BOX

RDB8 / RDB18 / RDB24

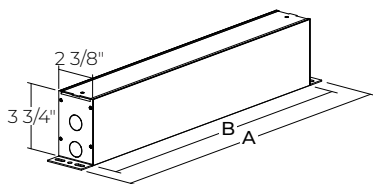

RDB24W

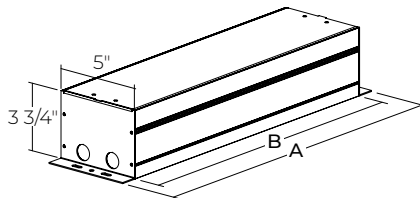

	RDB8	RDB18	RDB24	RDB24W
A	10"	20"	26"	26"
B	8"	18"	24"	24"
DRIVER	RD1 - 1% 0-10V RELV - ELV 120V RTRI - TRIAC 120V SOLA RSD1 - Single 0-10V input RSELV - ELV 120V RSTRI - TRIAC 120V	RLDE1 - Lutron Hi-lume 1% Eco RDA - DALI RELD1 - eldoLED 1% ECOdrive 0-10V RELD0 - eldoLED 0.1% SOLOdrive 0-10V	Emergency battery (+EB) with the following driver options. RD1+EB - 1% 0-10V RELV+EB - ELV 120V RTRI+EB - TRIAC 120V DUO RDMX - DMX RDDA - DALI DT6 RDDA8 - DALI DT8 RDD1 - Dual 0-10V input for CCT/intensity RLD2 - Lutron DALI-2 digital	Emergency battery (+EB) with the following driver options. RLDE1+EB - Lutron Hi-lume 1% Eco RDA+EB - DALI RELD1+EB - eldoLED 1% ECOdrive 0-10V RELD0+EB - eldoLED 0.1% SOLOdrive 0-10V

FLAIR 3" DIFFUSER

CYLINDER WALL

DIRECT/INDIRECT, DIRECT, INDIRECT



Color Quality

COLOR QUALITY - 3500K

TM-30 Rr	90
TM-30 Ra	100
CRI	90
R9	> 50

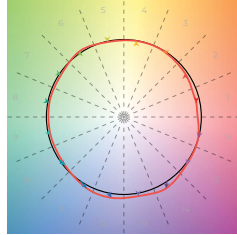

Photometrics

Values calculated based on 3500K.

DIRECT OPTIC - DIFFUSER

Fully frosted 1/4"

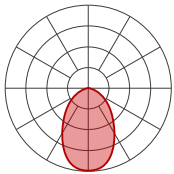

Delivered lumens

CRI	90 CRI	95 CRI	80 CRI
10 W	664	510	709
14 W	901	693	963
20 W	1237	951	1322

Efficacy

CRI	90 CRI	95 CRI	80 CRI
10 W	66	51	71
14 W	64	49	69
20 W	62	48	66

Fully frosted 3/4"

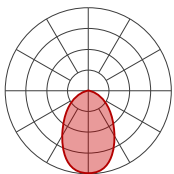

Delivered lumens

CRI	90 CRI	95 CRI	80 CRI
10 W	694	534	742
14 W	942	725	1007
20 W	1294	995	1383

Efficacy

CRI	90 CRI	95 CRI	80 CRI
10 W	69	53	74
14 W	67	52	72
20 W	65	50	69

Partially frosted 3/4"

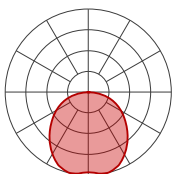

Delivered lumens

CRI	90 CRI	95 CRI	80 CRI
10 W	660	507	705
14 W	896	689	957
20 W	1230	946	1315

Efficacy

CRI	90 CRI	95 CRI	80 CRI
10 W	66	51	71
14 W	64	49	68
20 W	61	47	66

MULTIPLIERS

Please follow the multiplier table to ensure correct lumen value.

CCT

2700K	0.9
3000K	0.95
3500K	1
4000K	1.05

For SOLA and DUO, please consult factory.

FLAIR 3" DIFFUSER

CYLINDER WALL

DIRECT/INDIRECT, DIRECT, INDIRECT



INDIRECT OPTIC - DIFFUSER

Fully frosted 1/4"

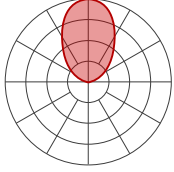

Delivered lumens

CRI	90 CRI	95 CRI	80 CRI
10 W	664	510	709
14 W	901	693	963
20 W	1237	951	1322

Efficacy

CRI	90 CRI	95 CRI	80 CRI
10 W	66	51	71
14 W	64	49	69
20 W	62	48	66

Fully frosted 3/4"

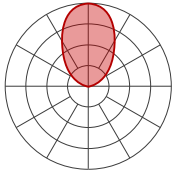

Delivered lumens

CRI	90 CRI	95 CRI	80 CRI
10 W	694	534	742
14 W	942	725	1007
20 W	1294	995	1383

Efficacy

CRI	90 CRI	95 CRI	80 CRI
10 W	69	53	74
14 W	67	52	72
20 W	65	50	69

Partially frosted 3/4"

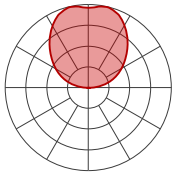

Delivered lumens

CRI	90 CRI	95 CRI	80 CRI
10 W	660	507	705
14 W	896	689	957
20 W	1230	946	1315

Efficacy

CRI	90 CRI	95 CRI	80 CRI
10 W	66	51	71
14 W	64	49	68
20 W	61	47	66

MULTIPLIERS

Please follow the multiplier table to ensure correct lumen value.

CCT	
2700K	0.9
3000K	0.95
3500K	1
4000K	1.05

For SOLA and DUO, please consult factory.

DIRECT/INDIRECT - EFFICACY CALCULATION

For Direct/Indirect performance values, follow the formula.

$$\frac{\left(\begin{array}{c} \text{DIRECT} \\ \text{DELIVERED LM} \end{array} + \begin{array}{c} \text{INDIRECT} \\ \text{DELIVERED LM} \end{array} \right)}{\left(\begin{array}{c} \text{DIRECT} \\ \text{WATTAGE} \end{array} + \begin{array}{c} \text{INDIRECT} \\ \text{WATTAGE} \end{array} \right)} = \text{EFFICACY}$$

FLAIR 3" DIFFUSER

CYLINDER WALL

DIRECT/INDIRECT, DIRECT, INDIRECT



Technical Specifications

LIGHT SOURCE

Static white

Compact COB (Chip-On-Board) LED module, available in 2700K, 3000K, 3500K and 4000K with a choice of 80 CRI, 90 CRI, or 95 CRI, with elevated R9 value for 90 CRI and above. Color consistency is maintained to within 2 SDCM. All LEDs have been tested in accordance with IESNA LM-80-08 and the results have shown L80 lumen maintenance greater than 60,000 hours. Absolute product photometry is measured and presented in accordance with IESNA LM-79, unless otherwise indicated.

Full spectrum

The full spectrum LED option offers improved color particularly in the cyan region which helps increase Cyanosis Observation Index (COI) and assist in regulating circadian rhythms. The cyan region in full spectrum LED is richer at the 480 nm range.

Chromawerx SOLA

Chromawerx SOLA is single-channel control that dims output while warming the color temperature in a pre-determined relationship. A simple analog control adjusts a specially populated LED array to emulate the effect of dimming a filament source.

Chromawerx DUO

Chromawerx DUO offers a two-channel control system which uses analog or digital protocols for synchronous control of both cool (6500K) to warm (2700K) LED arrays - maintaining a CRI above 90. The range of color DUO offers is useful for entraining circadian rhythms, stimulating alertness, and compensating for jet lag among other applications. The Chromawerx drivers are programmed to limit maximum light output and power usage across all color temperatures. When paired with DALI drivers (DDA/DDA8), color tuning follows a linear dimming curve.

ELECTRICAL

Unless otherwise specified, dimming down to 1%. At maximum driver load: efficiency > 84%, PF > 0.9, THD < 20%.

Integral: 0-10V, ELV, TRIAC

Remote: 0-10V, ELV, TRIAC, Lutron Hi-Lume 1% 2-wire and 1% EcoSystem, DALI, eldoLED 0.1% SOLOdrive 0-10V, eldoLED 1% ECOdrive 0-10V, DMX, Lutron DALI-2 digital

Emergency battery option: Remotely-installed, long-life, high-temperature, maintenance-free, Bodine Lithium-Ion battery pack with self-test functionality, test switch and charge indicator. IOTA and Fulham options available upon request. Minimum of 90 minutes operation, and recharge time of 24 hours. For fixtures less than 10 W, the battery provides 6 W of emergency light output. For fixtures 10 W and over, the battery provides 10 W.

PoE

Depending on the PoE manufacturer selected, Lumenwerx will install the node in factory as either integral to the luminaire or as a remote module. Factory programming of the PoE node may or may not enable the following functionalities: lumen package, DUO (tunable white), QUADRO (RGBW), emergency battery backup, and sensor integration. These must be addressed and evaluated on a case-by-case basis.

CONSTRUCTION

Housing: Die-cast and extruded aluminum

Canopy: Flat and direct

Arm: Machined aluminum

Finish: Textured matte white, black, and champagne. Custom colors also available (provide RAL #).

Diffuser: Acrylic

Heat sink: Die-cast aluminum

WEIGHT

Direct/Indirect	Direct or Indirect
6": 2.2 lbs - 1 kg	6": 2 lbs - 0.9 kg
8": 2.4 lbs - 1.1 kg	8": 2.2 lbs - 1 kg
12": 2.9 lbs - 1.3 kg	12": 2.4 lbs - 1.1 kg

CERTIFICATION

ETL: Rated for indoor dry/damp locations. Conforms to UL Standard 1598 and certified to CAN/CSA Standard C22.2 No. 250.0.

WARRANTY

Lumenwerx provides a five-year limited warranty of electrical and mechanical performance of the luminaires, including the LED boards, drivers, and auxiliary electronics. Lumenwerx will repair or replace defective luminaires or components at our discretion, provided they have been installed and operated in accordance with our specifications. Other limitations apply, please refer to the full warranty on our website.