

PETITE DOWNLIGHT

ROUND RECESSED WALL WASH



Flanged Trim



Flush Flanged Trim



The Petite family strikes that perfect balance of compact size, streamlined aesthetics, and high performance. Through their 1" lens apertures, these meticulously engineered downlight, cylinder, and multi-aperture luminaires breathe light into spaces with a quiet, straightforward sophistication.

Beam Angle



Wall Wash

Light Source

Static White

SOLA

DUO



Performance

LUMEN OUTPUT ¹	WATTS	EFFICACY
243 lm	7 W	35 lm/W
316 lm	10 W	32 lm/W
422 lm	14 W	30 lm/W

¹Lumen packages are assuming 3500K, 90 CRI, 45° beam, flush trim.

Ceiling Types



Drywall



Millwork



Acoustic Tile

Plenum Clearance

As low as 1 3/4"



Petite Family (Refer to other spec sheets)

Downlight



Adjustable



Recessed



Wall Wash

Multi-aperture



Adjustable



Recessed



Wall Wash

Cylinder



Pendant



Surface

PETITE DOWNLIGHT

ROUND RECESSED WALL WASH



Project: _____

Type: _____

Order Guide

LUMINAIRE ID ¹	TRIM STYLE	LENS	CEILING THICKNESS	INSTALLATION TYPE ²	MOUNTING OPTION ⁵
PETMRRWW		WW			
PETRRWW - Petite Round Recessed Wall Wash ¹ Recessed (fixed) and Recessed Adjustable also available. Consult other spec sheets.	TRM - Flanged trim TRMP - Flush flanged trim drywall mudplate TRMW - Flush flanged trim millwork	WW - Wall wash diffuser	05IN - Up to 0.5" 1IN - 0.5" - 1"	IC³ - Type-IC NIC⁴ - Type Non-IC CP³ - Chicago Plenum Type-IC (CCEA) ² See page 3 for more details. ³ Up to 10 W with 90 CRI. ⁴ Up to 14 W with 90 CRI.	ASB - Adjustable standard bar hangers FMB - Flush mount bars ACB - Adjustable commercial bar hangers AHC - Adjustable hat channel bars NA - None ⁵ See page 5 for more detail

LIGHT SOURCE	BEAM	COLOR QUALITY	CRI	COLOR TEMPERATURE	DRIVER
	WW				
SW - Static white SOLA - Dim-to-warm single channel control DUO - Tunable white 2-channel control	WW - Wall wash	2STP - 2 Step MacAdam Ellipse 3STP - 3 Step MacAdam Ellipse 3STP - 3 Step MacAdam Ellipse	90CRI - 90 CRI 95CRI - 95 CRI 80CRI - 80 CRI 90CRI - 90 CRI	27K - 2700K 30K - 3000K 35K - 3500K 40K - 4000K SOLA 30K18K - 3000K to 1800K 27K18K - 2700K to 1800K DUO 65K27K - 6500K to 2700K 50K27K - 5000K to 2700K	INTEGRAL⁶ ⁶ Access above the ceiling is required. REMOTE⁷ ⁷ A remote driver box is provided, see page 4 for details.

VOLTAGE	WATTAGE	DIMMING ¹²	BAFFLE FINISH	TRIM FLANGE FINISH
120V - 120V 277V - 277V UNV - 120V-277V	7W - 7 W, up to 243 lm 10W⁹ - 10 W, up to 316 lm 14W¹⁰ - 14 W, up to 422 lm ⁹ Available with 90 CRI when specified with Type-IC/CP. ¹⁰ Only available with 90 CRI when specified with Type-NIC. ¹¹ Not available with Type-IC/CP.	D1 - 1% 0-10V ELV¹³ - ELV 120V TRI¹³ - TRIAC 120V ELD1 - eldoLED 1% ECOdrive 0-10V ELD0 - eldoLED 0.1% SOLOdrive 0-10V PEQ0* - Lutron Hi-lume Premier 0.1% EcoSystem ¹² PoE (Power-over-Ethernet) compatible. Consult factory for details. ¹³ Available with 120V only. *On-site commissioning is required.	FTMW - Textured matte white FTMB - Textured matte black FSPC - Specular FSSPC - Semi-specular FCHP - Champagne CF# - Custom finish, specify RAL# NA - Not applicable	FTMW - Textured matte white FTMB - Textured matte black FSPC - Specular FSSPC - Semi-specular FCHP - Champagne CF# - Custom finish, specify RAL# NA - Not applicable
	SOLA 10W - 10 W output, up to 269 lm 14W¹¹ - 10 W output, up to 358 lm	SOLA SD1 - Single 0-10V input SELV¹³ - ELV 120V STRI¹³ - TRIAC 120V		

FOR FULL REMOTE DRIVER SPECIFICATION, SEE "REMOTE DRIVER" SECTION BELOW.

REMOTE DRIVER

Ordered separately. Specify each required remote driver box on a separate line.

REMOTE DRIVER ¹⁴	LUMINAIRE QTY.	LUMINAIRE ID	VOLTAGE	WATTAGE	DIMMING ¹⁸
RDB					
RDB - Remote driver ¹⁴ Specify each required remote driver box on a separate line.	1X - 1 luminaire 2X - 2 luminaires 3X - 3 luminaires	PETRRWW - Petite Round Recessed Wall Wash	120V - 120V 277V - 277V UNV - 120V-277V 347V¹⁵ - 347V ¹⁵ Available with RD1 driver only. Please consult factory.	7W - 7 W, up to 605 lm 10W - 10 W, up to 798 lm 14W¹⁶ - 14 W, up to 1074 lm 16W¹⁷ - 14 W, up to 1163 lm ¹⁶ Only available with 90 CRI when specified with Type-IC/CP. ¹⁷ Not available with Type-IC/CP.	RD1 - 1% 0-10V RELV¹⁹ - ELV 120V RTRI¹⁹ - TRIAC 120V RLDE1²⁰ - Lutron Hi-lume 1% Eco RDA²⁰ - DALI ¹⁹ Available with 120V only. ²⁰ On-site commissioning is required. ²¹ For emergency battery, code will be like the following example: RD1+EB.
				SOLA 10W - 10 W output, up to 428 lm 14W¹⁷ - 10 W output, up to 567 lm DUO 7W - 7 W output, up to 251 lm	DUO RDMX²⁰ - DMX RDDA²⁰ - DALI DT6 RDDA8²⁰ - DALI DT8 RDD1 - Dual 0-10V input for CCT/intensity RPSQO²⁰ - Lutron T-Series 1% tunable white

EXAMPLE CODE:

LIGHT	PETRRWW-TRM-WW-05IN-IC-ASB-SW-WW-2STP-90CRI-35K-UNV-7W-D1-FTMW-FTMW	REMOTE DRIVER	RDBC-2X-PETRRWW-RD1 RDBC-1X-PETRRWW-RD1
--------------	---	----------------------	--



PETITE DOWNLIGHT

ROUND RECESSED WALL WASH



Installation Types

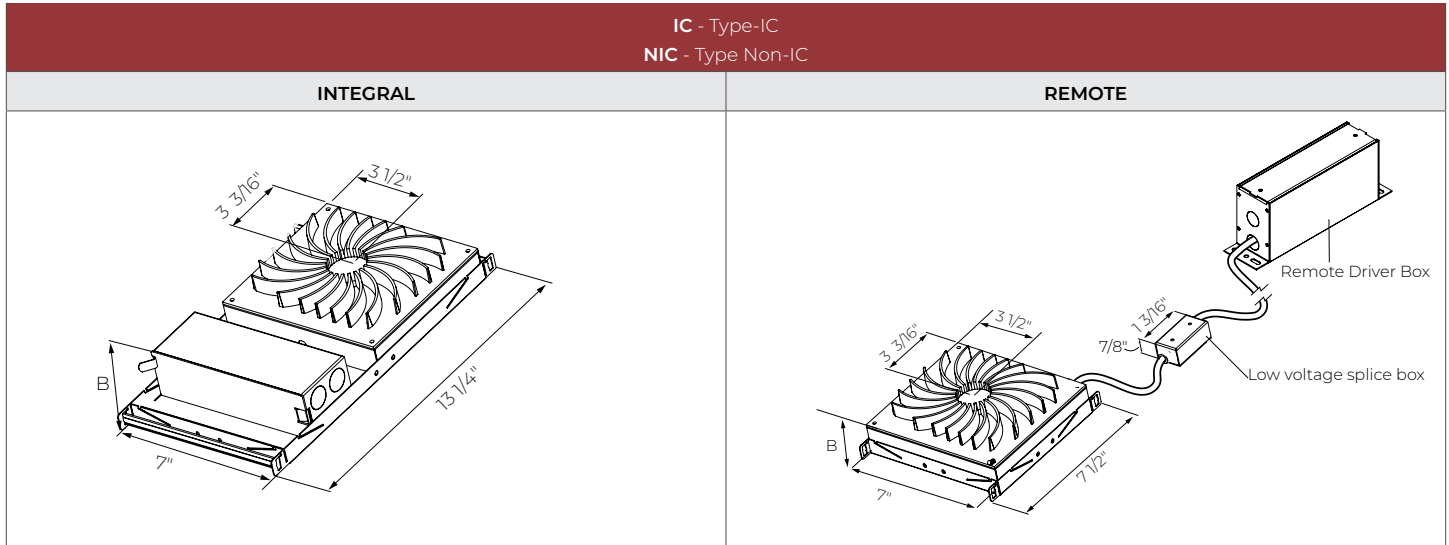

For integral, access above the ceiling is required.
For dimension B, see the PLENUM CLEARANCE table below.

PLENUM CLEARANCE

CUT-OUT DIMENSIONS

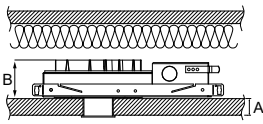

IC - Insulated ceiling

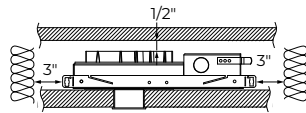

NIC² - Non-insulated ceiling
² No insulation within 3" of the fixture.

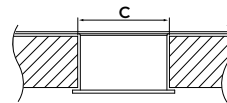

TRM - TRMP

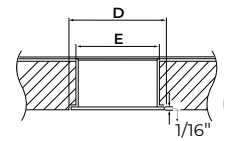

TRMW

PLENUM CLEARANCE HEIGHT AND CEILING THICKNESS					
		IC - TYPE IC		NIC - TYPE NON-IC	
A	Ceiling Thickness	1IN	0.5IN	1IN	0.5IN
B	Integral	2 1/8" (FMB) 4" (ASB, ACB, AHC)		2 5/8" (FMB) 4" (ASB, ACB, AHC)	
	Remote	1 3/4" (FMB) 4" (ASB, ACB, AHC)	2 1/8" (FMB) 4" (ASB, ACB, AHC)	2 1/4" (FMB) 4" (ASB, ACB, AHC)	2 5/8" (FMB) 4" (ASB, ACB, AHC)

CUT-OUT DIMENSIONS				
		Drywall	Acoustic Tile	Millwork
C	TRM	Ø 1 11/16"		N/A
	TRMP	Ø 1 1/16"	N/A	
D	TRMW	N/A		Ø 1 13/16"
E				Ø 1 11/16" with 1/16" lip

PETITE DOWNLIGHT ROUND RECESSED WALL WASH



REMOTE DRIVER BOX

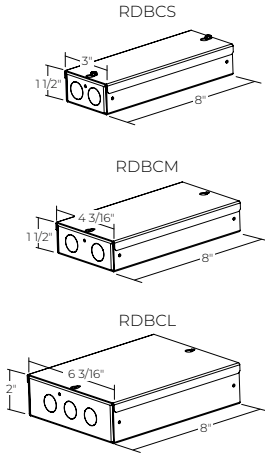

DRIVER	RDB	# DRIVERS
RD1	RDBCS	1X
	RDBCM	2X
	RDBCL	3X
RELV RTRI RDA RELD0 RELD1	RDBCS	1X
	RDBCM	2X, 3X

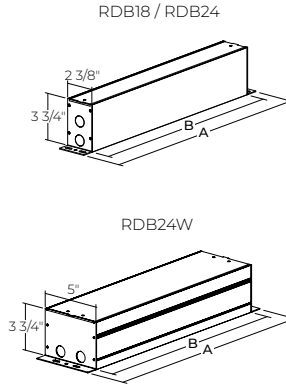

DRIVER	RDB	A	B
RLDE1	RDB18	20"	18"
RDMX RDDA RDDA8 RDD1 RPSQ0	RDB24	26"	24"
RD1+EB RELV+EB RTRI+EB			
RLDE1+EB RDA+EBI RELD1+EB RELD0+EB	RDB24W	26"	24"

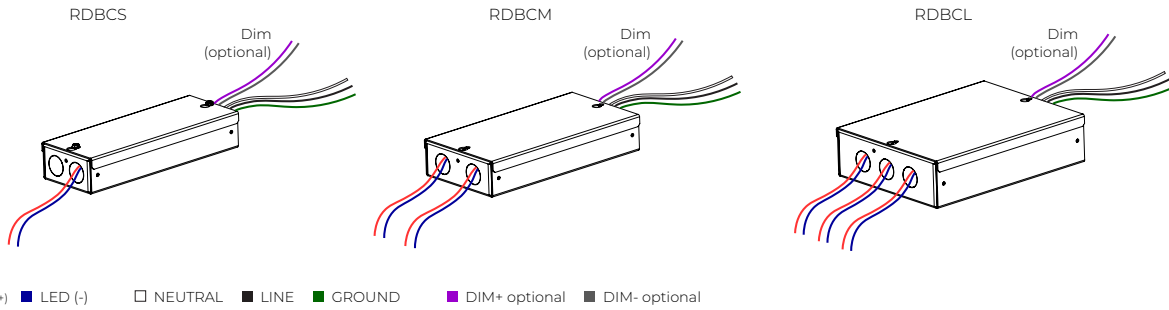

PETITE DOWNLIGHT

ROUND RECESSED WALL WASH



Mounting Options

ASB - Adjustable Standard Bar Hangers

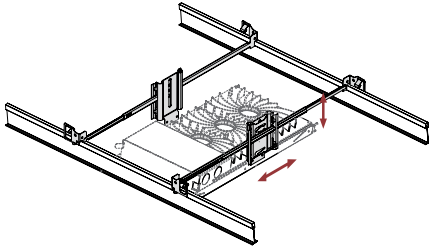

Adjustable Standard Bar hangers can be used in both commercial and residential applications and are adjustable to various heights in both Grid Ceiling and Drywall mounting. ASB hangers are less rigid and versatile than ACB hangers.

FMB - Flush Mount Bars

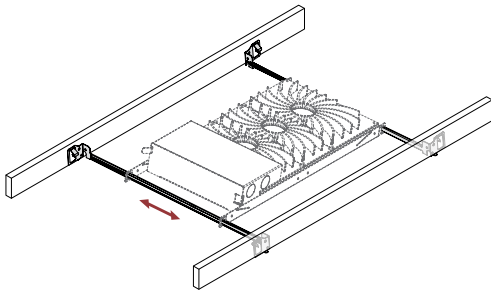

Flush Mount Bars are best used in residential applications, fitting snug to the surface and suitable for Wood, Metal, and Drywall mounting. The flush mounted bars are static and can't be adjusted.

ACB - Adjustable Commercial Bar Hangers

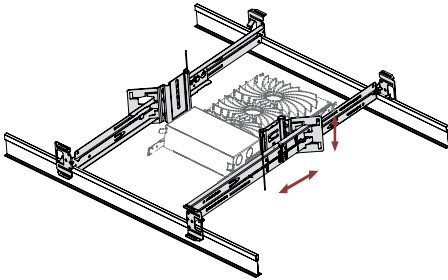

Adjustable Commercial Bar hangers can be used in both commercial and residential applications and are by far the most versatile mounting bar we offer with its adjustability to various heights. ACB hangers are suitable for Grid Ceiling, Drywall, Metal, Wood and Frame mounting.

- Extremely rigid
- Fits into C-Channel notches in a Butterfly Bracket

AHC - Adjustable Hat Channel Bars

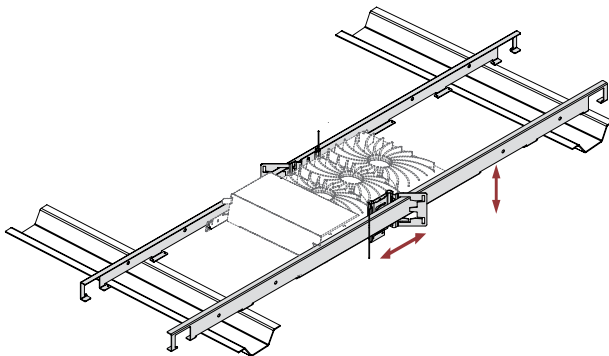

Adjustable Hat Channel bars can be used in both commercial and residential applications and come with a butterfly clip to adjust to various heights. AHC bars can be hung downward by 90 degrees in vertical position, and once wired, can be shifted onto the horizontal mounting plane. AHC bars are suitable for both Drywall and wood ceiling applications.

PETITE DOWNLIGHT

ROUND RECESSED WALL WASH

Trim Style

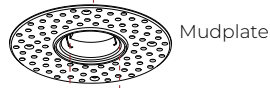
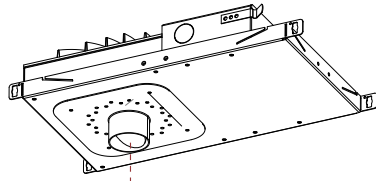

TRM
Flanged trim



TRMP
Flush flanged trim drywall
mudplate



TRMW
Flush flanged trim
millwork

TRM - Flanged Trim	TRMP - Flush Flanged Trim Drywall Mudplate TRMW - Flush Flanged Trim Millwork

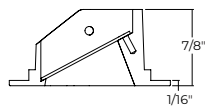
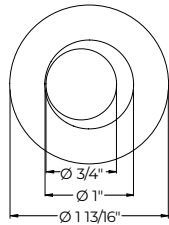

PETITE DOWNLIGHT

ROUND RECESSED WALL WASH



Color Quality

COLOR QUALITY - 3500K	
TM-30 R _r	91
TM-30 R _g	100
CRI	90
R9	> 50

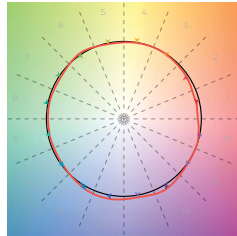

Photometrics

Values calculated based on 3500K, 90 CRI, and with no lens.
The light distribution will vary depending on baffle finish and trim style.

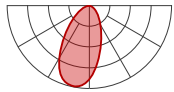

WW - Wall Wash

WATTAGE		7W		10W		14W	
Trim Style	Baffle Finish	lm	lm/W	lm	lm/W	lm	lm/W
Trim	White	243	35	316	32	422	30
	Black Champagne	190	27	246	25	328	23
	Specular Semi-specular	217	31	281	28	375	27
Trimless	White	NA	NA	NA	NA	NA	NA
	Black Champagne	NA	NA	NA	NA	NA	NA
	Specular Semi-specular	NA	NA	NA	NA	NA	NA

MULTIPLIERS

Please follow the multiplier tables to ensure correct lumen value. CCT, CRI, and lensing will change the lumen value.

CCT	
2700K	0.91
3000K	0.96
3500K	1
4000K	1.01

CRI	
80 CRI	1
90 CRI	1
95 CRI	0.77

For SOLA and DUO, please consult factory.



PETITE DOWNLIGHT

ROUND RECESSED WALL WASH



Technical Specifications

OPTIC

The CircaFlex™ Optic uses advanced beam-splitting technology to allow light to follow an intended optical path with maximal precision, minimal spread, and even distribution.

LIGHT SOURCE

Compact COB (Chip-On-Board) LED module, available in 2700K, 3000K, 3500K and 4000K with a choice of 80 CRI, 90 CRI, or 95 CRI, with elevated R9 value for 90 CRI and above. Color consistency is maintained to within 2 SDCM. All LEDs have been tested in accordance with IESNA LM-80-08 and the results have shown L80 lumen maintenance greater than 60,000 hours. Absolute product photometry is measured and presented in accordance with IESNA LM-79, unless otherwise indicated.

CHROMAWERX

Chromawerx SOLA

Chromawerx SOLA is single-channel control that dims output while warming the color temperature in a pre-determined relationship. Two color temperature range options are offered: 3000K to 1800K, and 2700K to 1800K. A simple analog control adjusts a specially populated LED array to emulate the effect of dimming a filament source.

Chromawerx DUO

Chromawerx DUO offers a two-channel control system which uses analog or digital protocols for synchronous control of both cool to warm LED arrays - maintaining a CRI above 90. Two color temperature range options are offered: 6500K to 2700K, and 5000K to 2700K. The range of color DUO offers is useful for entraining circadian rhythms, stimulating alertness, and compensating for jet lag among other applications. The Chromawerx drivers are programmed to limit maximum light output and power usage across all color temperatures. When paired with DALI drivers (DDA/DDA8), color tuning follows a linear dimming curve.

ELECTRICAL

Unless otherwise specified, dimming down to 1%. At maximum driver load: efficiency > 84%, PF > 0.9, THD < 20%.

Integral: 0-10V, ELV, TRIAC, eidoLED 1% ECOdrive 0-10V, eidoLED 0.1% SOLOdrive 0-10V, Lutron Hi-lume Premier 0.1% EcoSystem.

Remote: 0-10V, ELV, TRIAC, Lutron Hi-lume 1% Eco, DALI, eidoLED 1% ECOdrive 0-10V, eidoLED 0.1% SOLOdrive 0-10V, Lutron Hi-lume Premier 0.1% EcoSystem, DMX, Lutron T-series (tunable white).

Emergency Battery Option: Remotely-installed, long-life, high-temperature, maintenance-free, Bodine Lithium-Ion battery pack with self-test functionality, test switch and charge indicator. IOTA and Fulham options available upon request. Minimum of 90 minutes operation, and recharge time of 24 hours. For fixtures less than 10W, the battery provides 6W of emergency light output. For fixtures 10W and over, the battery provides 10W.

PoE

Depending on the PoE manufacturer selected, Lumenwerx will install the node in factory as either integral to the luminaire, or as a remote module. Factory programming of the PoE node may or may not enable the following functionalities: lumen package, DUO (tunable white), QUADRO (RGBW), emergency battery backup, and sensor integration. These must be addressed and evaluated on a case-by-case basis.

CONSTRUCTION

Housing: For new construction, 20 gauge powder coated steel. 18 gauge galvanized steel junction box with ½" trade size knockouts. Adjustable hanger bars and butterfly brackets are included. Adjustable commercial hat channel and flush mounted brackets are also available.

Baffle: Die-cast aluminum mounted with retaining spring clips

Heat sink: Die-cast aluminum

WEIGHT

Integral: 4 lbs - 1.8 kg

Remote: 2.1 lbs. - 0.95 kg

LENS



Wall Wash

ENVIRONMENT

Ambient temperature at fixture location shall be within 0°C/32°F - 25°C/77°F, indoor dry or damp as well as outdoor damp use (canopies or marquees)

CERTIFICATION

ETL: Rated for Indoor dry/damp locations. Conforms to UL Standard 1598 and certified to CAN/CSA Standard C22.2 No. 250.0.

WARRANTY

Lumenwerx provides a five-year limited warranty on electrical and mechanical performance of the luminaires, including the LED boards, drivers, and auxiliary electronics. Lumenwerx will repair or replace defective luminaires or components at our discretion, provided they have been installed and operated in accordance with our specifications. Other limitations apply, please refer to the full warranty on our website.