

POP RECESSED SQUARE

DRYWALL MOUNT - INSTRUCTIONS

NOTE: Wire dimming conductors as Class 1

1 FLUSH

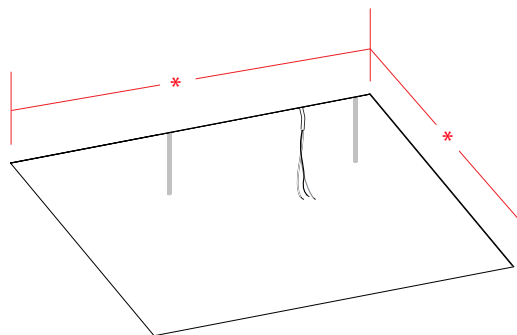

Cut hole in the drywall according to the dimension [*] given in the client drawings.

2

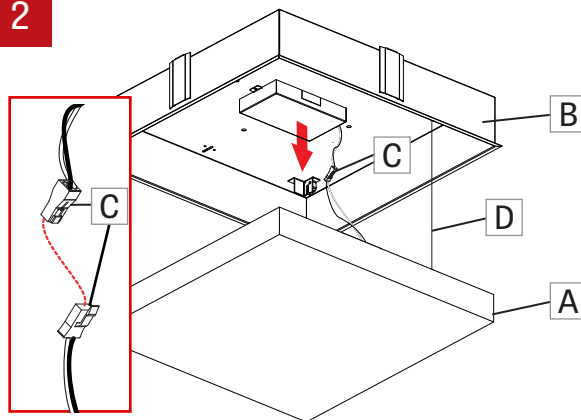

Push slowly the diffuser (A) until it unlocked. Lower the diffuser (A) from the housing (B). Disconnect quick connectors (C) between driver and diffuser (A). Remove security cable (D).

3

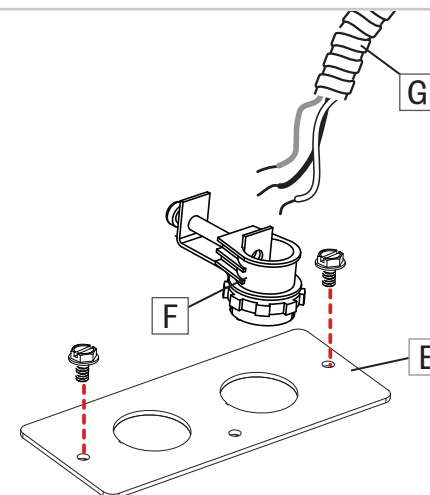

Rotate fixture and remove power plate (E) from fixture. Install BX connector (F) (by other) and BX cable (G) (by other) through the power plate. Tighten BX connector (F) screw.

4

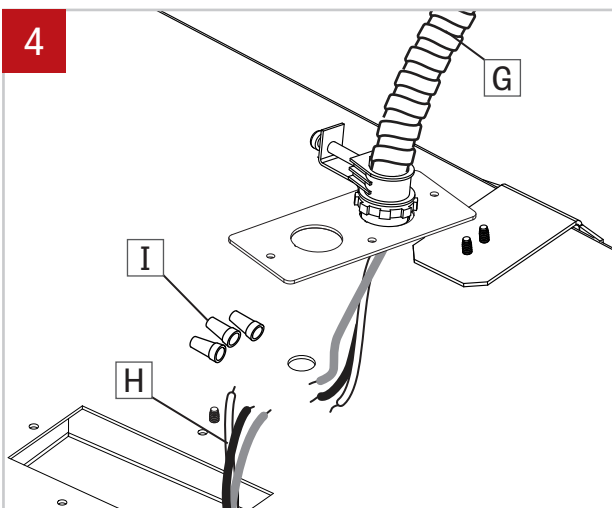

Connect wires from the BX cable (G) to the fixture driver wires (H) using wire nuts (I). Ensure connections comply with local and national electrical codes.

5

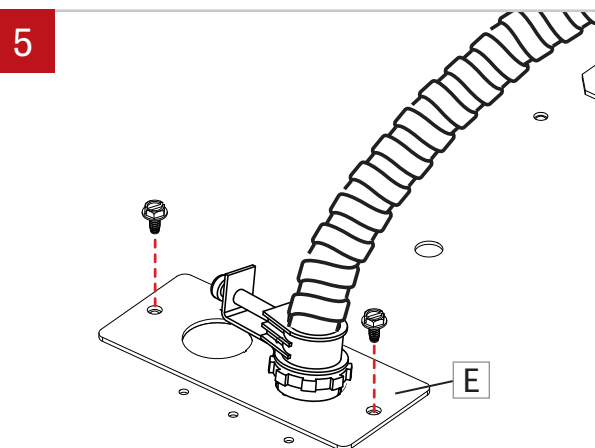

Push connected wires inside the fixture. Reinstall power plate (E) onto fixture by refastening screws to power plate (E) and fixture.

6

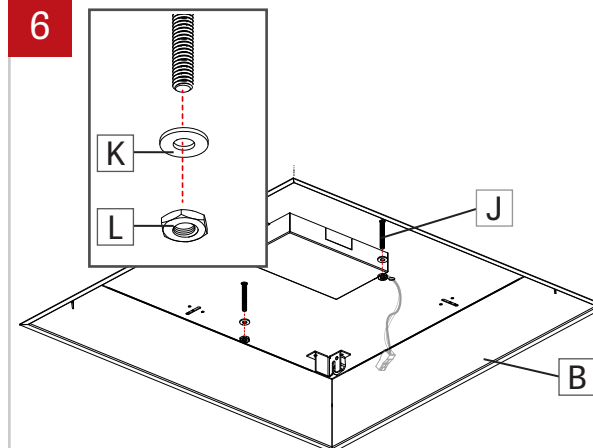

Insert fixture's housing (B) into pre-cut hole in drywall, aligning threaded rods (J) with holes in top of the fixture's housing (B). Put washers (K) and tighten nuts (L) to secure the fixture's housing (B).

POP RECESSED SQUARE

DRYWALL MOUNT - INSTRUCTIONS

7

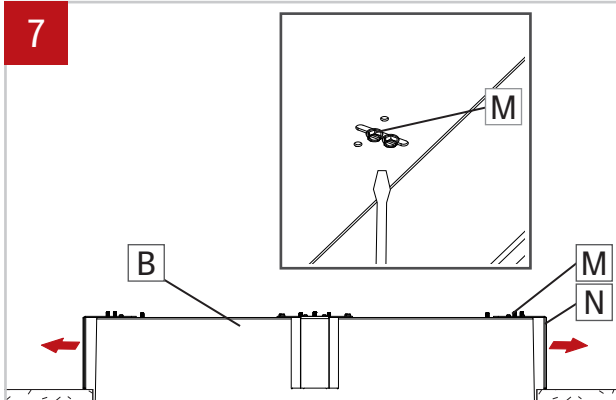

Untighten the screws (M) on the mounting brackets (N) and push the mounting brackets (N) away from housing. When brackets are fully extended, tighten the screws (M) back to secure the housing (B).

8

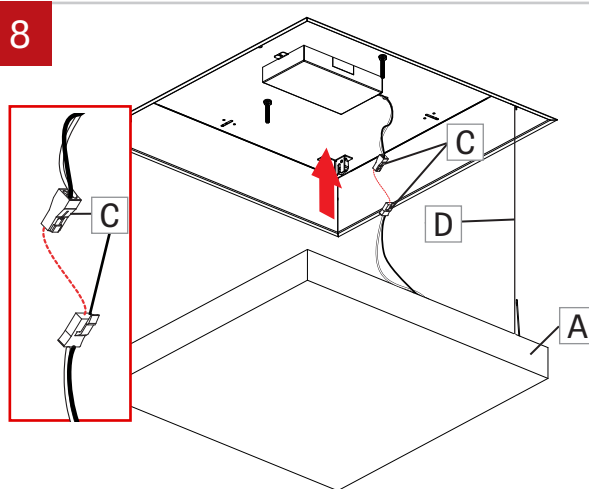

Attach security cable (D). Make the wires connection between the driver wires and the LED board (A) using the quick connectors (C).

9

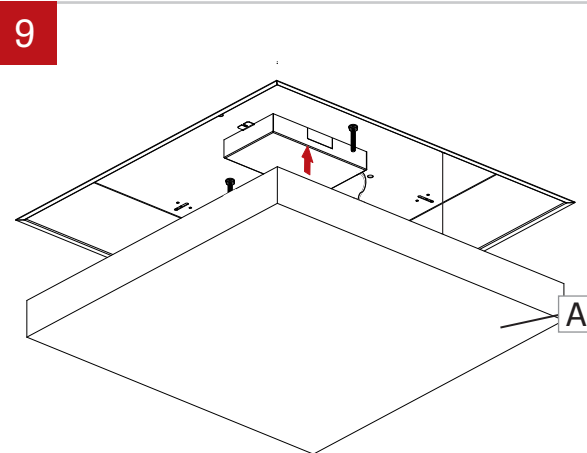

Carrefuly push back in place the LED board (A). after aligning the brackets.

10

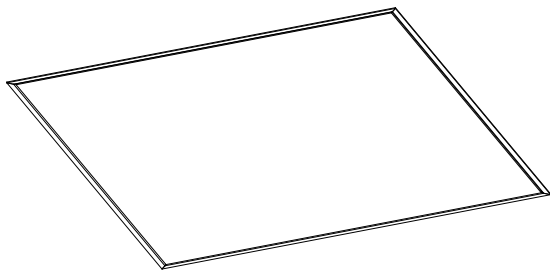

Power can be safely turned on.