

REVEN-CAMBER-SMILE ICL

DRIVER REPLACEMENT

IMPORTANT: Installation instructions are shown with Reven and applies to Reven, Camber and Smile fixtures

NOTE: Wire dimming conductors as Class 1

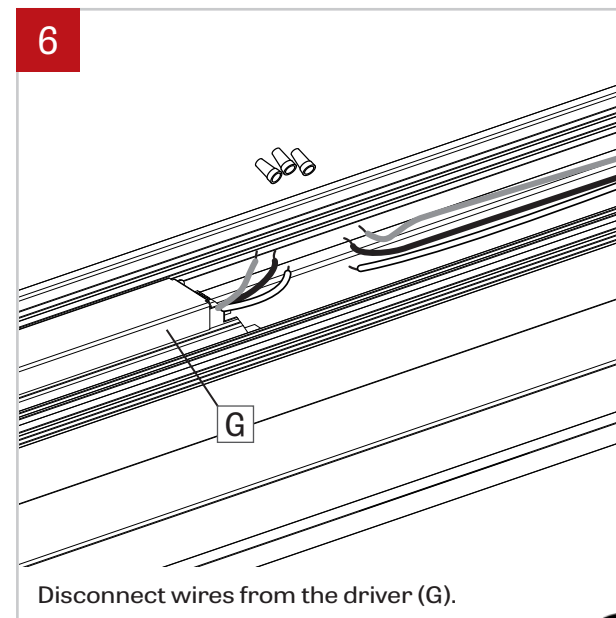
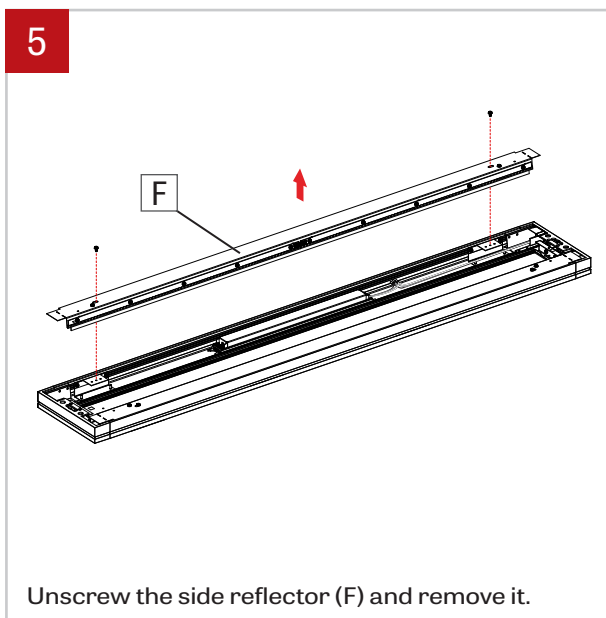
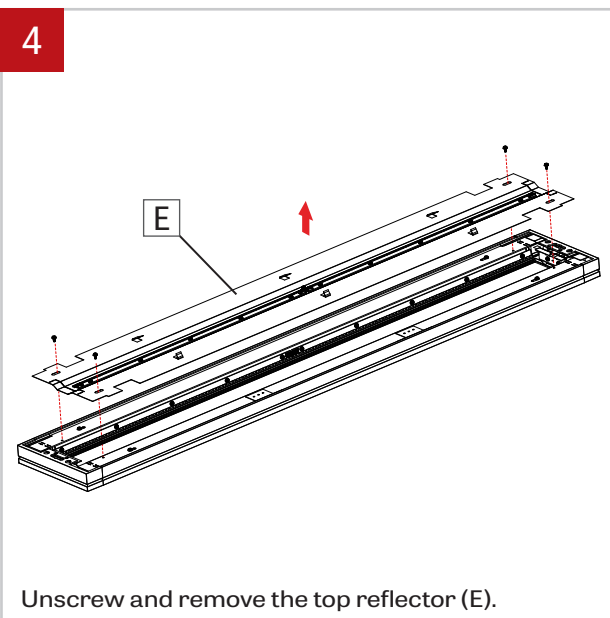
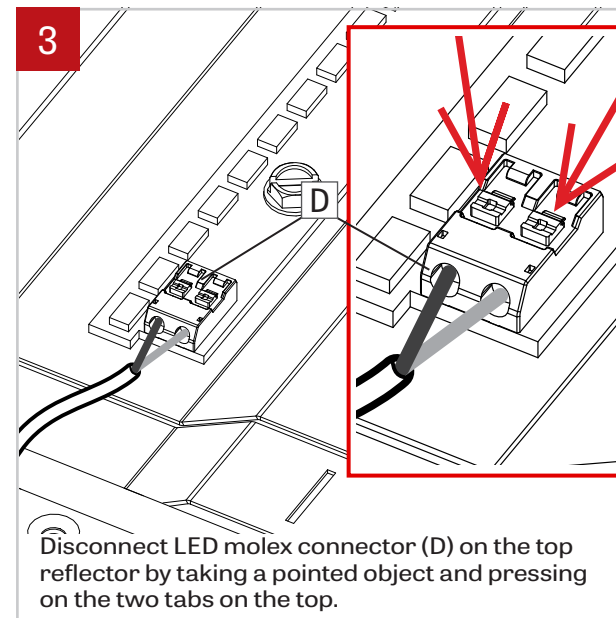
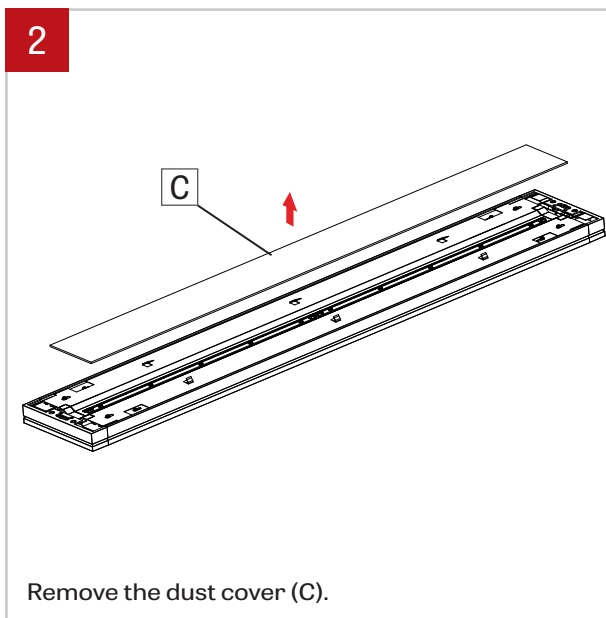
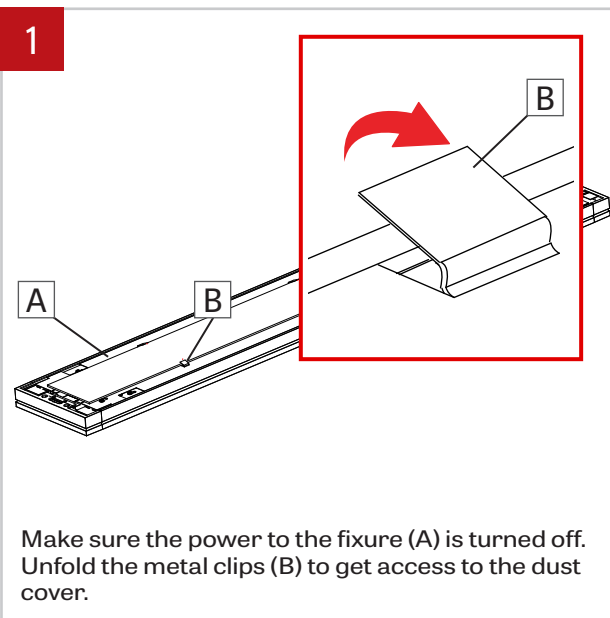

REVEN-CAMBER-SMILE ICL

DRIVER REPLACEMENT

7

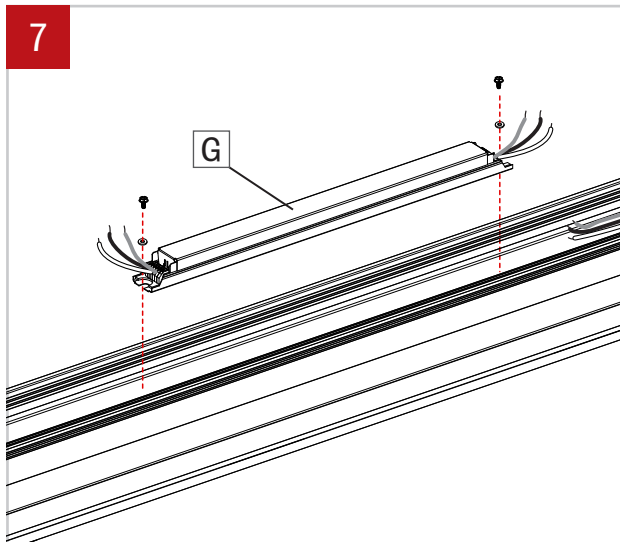

Unscrew the driver (G) from the fixture. Replace the driver and make connection with wire nuts.

8

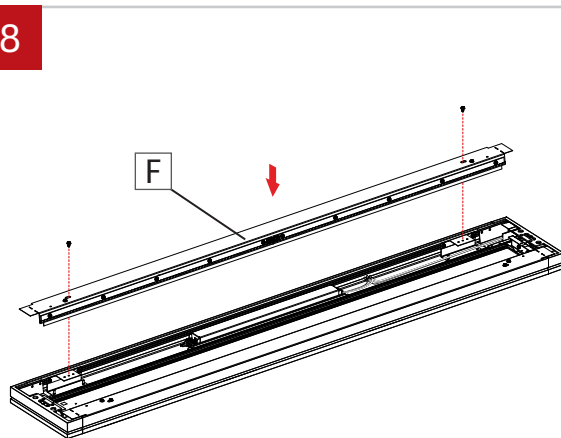

Screw the side reflector (F) back in place.

9

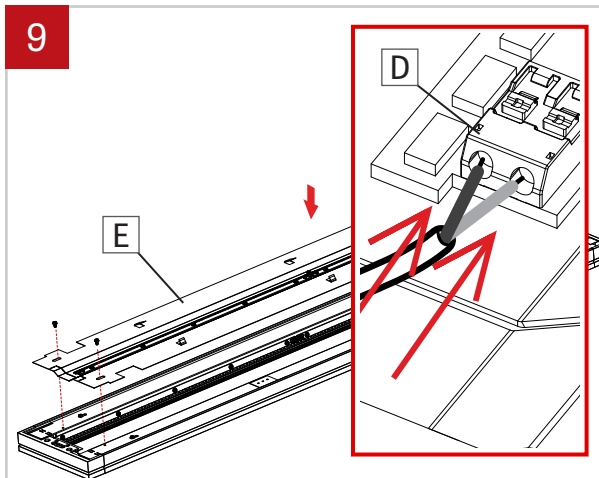

Replace the top reflectors (E) and reconnect the LED connector (D). Screw the top reflector (E) back in place.

10

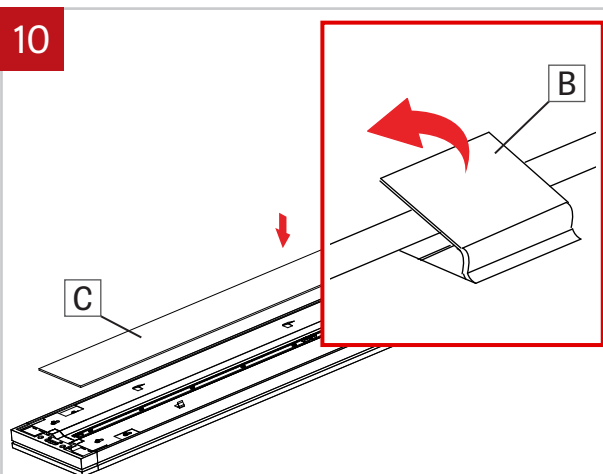

Put back in place the dust cover (C) and fold back the metal clips (B) to maintain the dust cover (C) in place.