

# RIM TUBE ROUND

PENDANT  
STATIC WHITE



Project: \_\_\_\_\_

Type: \_\_\_\_\_



## DESCRIPTION

Rim Tube introduces a refined tubular form to the Rim Collection with its minimalist 1.4" diameter. This versatile luminaire delivers bold expression through its clean geometry and striking illumination. Available in multiple shapes, configurations and sizes. Rim Tube maintains the signature sleek and minimalist aesthetic of the Rim family, scaling from simple geometric shapes to sculptural, multidimensional installations.

## Order Guide

LUMINAIRE ID	SIZE	OPTIC	LIGHT SOURCE <sup>1</sup>	CRI
<b>RIMTURP</b>		<b>ULO</b>	<b>SW</b>	<b>90CRI</b>
<b>RIMTURP</b> - Rim Tube Round Pendant	<b>12IN</b> - Ø 12" <b>18IN</b> - Ø 18" <b>24IN</b> - Ø 24" <b>36IN</b> - Ø 36"	<b>48IN</b> - Ø 48" <b>60IN</b> - Ø 60" <b>72IN</b> - Ø 72"	<b>ULO</b> - Uniform Lambertian Optic  <sup>1</sup> Chromawerx SOLA, DUO, and QUADRO also available. Consult factory.	<b>90CRI</b> - 90+ CRI

LUMEN PACKAGE	COLOR TEMPERATURE	VOLTAGE	REMOTE DRIVER	ELECTRICAL <sup>4</sup>
				<b>1C</b>
Ø 12" Low <b>1000LM</b> Ø 18" <b>1500LM</b> Ø 24" <b>2000LM</b> Ø 36" <b>3000LM</b> Ø 48" <b>4000LM</b> Ø 60" <b>5000LM</b> Ø 72" <b>6000LM</b>	<b>27K</b> - 2700K <b>30K</b> - 3000K <b>35K</b> - 3500K <b>40K</b> - 4000K	<b>120V</b> - 120V <b>277V</b> - 277V <b>UNV</b> - 120V-277V <b>347V</b> <sup>2</sup> - 347V  <sup>2</sup> Available with D1 driver only.	<b>D1</b> - 1% 0-10V <b>DA</b> <sup>3</sup> - DALI <b>LDE1</b> <sup>3</sup> - Lutron Hi-Lume 1% Eco <b>ELD1</b> - eldoLED 1% ECOdrive 0-10V <b>ELDO</b> - eldoLED0.1% SOLOdrive 0-10V  <sup>3</sup> On-site commissioning is required.	<b>1C</b> - 1 circuit  <sup>4</sup> For other circuit configurations, consult factory.

MOUNTING	FINISH

DRIVER BOX <sup>5</sup>	CANOPY FINISH	POWER	MOUNTING POINTS	MOUNTING CABLE LENGTH <sup>10</sup>	W - Matte white AL - Aluminum B - Matte black CF - Custom finish, specify RAL#																
<b>RCD</b> <sup>6,7</sup> - Round canopy driver box <b>RDB</b> - Remote driver box	<b>W</b> - Matte white <b>AL</b> - Aluminum <b>B</b> - Matte black <b>CF</b> - Custom finish, specify RAL#	<b>POC</b> - Integrated suspension power-over-aircraft cable <b>BAC</b> - Black power cord + aircraft cable <b>WAC</b> - White power cord + aircraft cable	<b>SC</b> - Single canopy <b>MC</b> <sup>8, 9</sup> - Multiple canopies  <sup>8</sup> 4 Canopies provided. <sup>9</sup> With the RCD option, the type of each canopy may differ based on the selected lumen package and driver options. Consult factory for details.	<b>18IN</b> - 18" <b>24IN</b> - 24" <b>36IN</b> - 36" <b>48IN</b> - 48" <b>60IN</b> - 60" <b>72IN</b> - 72" <b>96IN</b> - 96" <b>120IN</b> - 120" <b>##IN</b> - Specify nominal length in inches  <sup>10</sup> For single canopy option, the minimum required mounting heights are (distance from ceiling to top of fixture in inches): <table><tr><th>Fixture size</th><th>Minimum height</th></tr><tr><td>Ø 12"</td><td>8"</td></tr><tr><td>Ø 18"</td><td>11"</td></tr><tr><td>Ø 24"</td><td>15"</td></tr><tr><td>Ø 36"</td><td>22"</td></tr><tr><td>Ø 48"</td><td>29"</td></tr><tr><td>Ø 60"</td><td>36"</td></tr><tr><td>Ø 72"</td><td>43"</td></tr></table>	Fixture size	Minimum height	Ø 12"	8"	Ø 18"	11"	Ø 24"	15"	Ø 36"	22"	Ø 48"	29"	Ø 60"	36"	Ø 72"	43"	
Fixture size	Minimum height																				
Ø 12"	8"																				
Ø 18"	11"																				
Ø 24"	15"																				
Ø 36"	22"																				
Ø 48"	29"																				
Ø 60"	36"																				
Ø 72"	43"																				

# RIM TUBE ROUND

PENDANT  
STATIC WHITE



## Dimensions

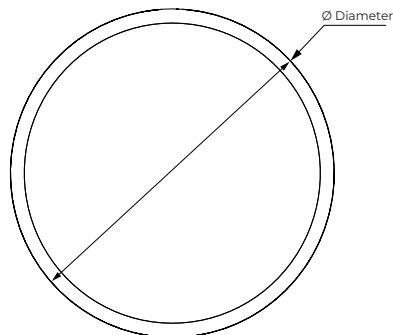

Size	Ø Diameter
Ø 12"	Ø 14 1/8"
Ø 18"	Ø 20 1/8"
Ø 24"	Ø 26 1/8"
Ø 36"	Ø 38 1/8"
Ø 48"	Ø 50 1/8"
Ø 60"	Ø 62 1/8"
Ø 72"	Ø 74 1/8"

## SECTION VIEW

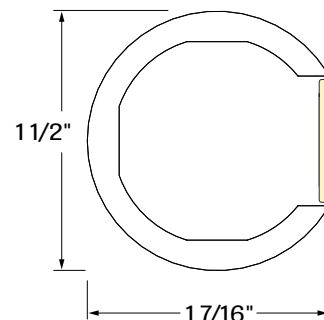

## Photometrics

Delivered lumens at 4000K at 90+ CRI

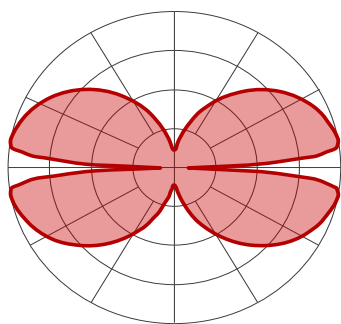

Ø 12"

LM	WATTS	LM/W
1000	11.1	90
1500	17.2	87

Ø 18"

LM	WATTS	LM/W
1500	16.7	90
2250	25.9	87

Ø 24"

LM	WATTS	LM/W
2000	22.2	90
3000	34.6	87

Ø 36"

LM	WATTS	LM/W
3000	33.4	90
4500	52	87

Ø 48"

LM	WATTS	LM/W
4000	44.5	90
6000	69.2	87

Ø 60"

LM	WATTS	LM/W
5000	55.6	90
7500	86.2	87

### MULTIPLIER TABLE

Use this table to get results for different color temperatures and CRI for all photometric tables.

CCT	WATTS	LPW
2700K	1.08	0.92
3000K	1.05	0.96
3500K	1.02	0.98
4000K	1.00	1.00

Ø 72"

LM	WATTS	LM/W
6000	66.7	90
9000	103.9	87

# RIM TUBE ROUND



PENDANT  
STATIC WHITE

## Mounting Options

### RCD - ROUND CANOPY DRIVER BOX

#### SC - SINGLE CANOPY

#### MC - MULTIPLE CANOPY

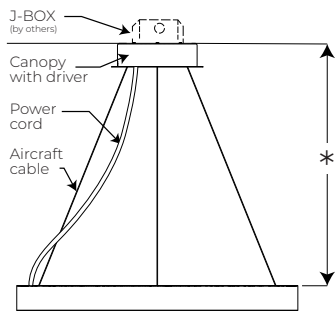

AC - Aircraft cable

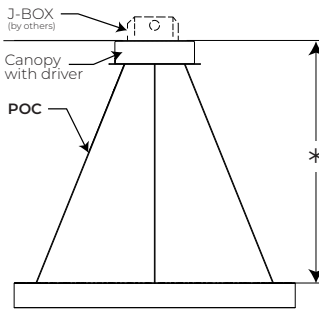

POC - Power-over-aircraft cable

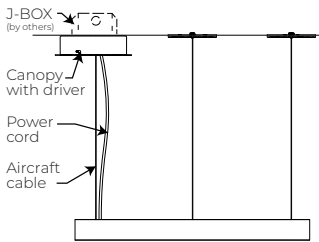

AC - Aircraft cable

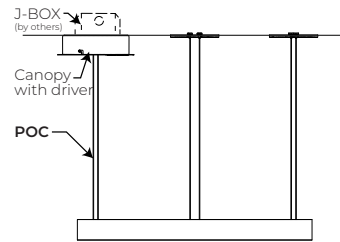

POC - Power-over-aircraft cable

### RDB - REMOTE DRIVER BOX

#### SC - SINGLE CANOPY

#### MC - MULTIPLE CANOPY

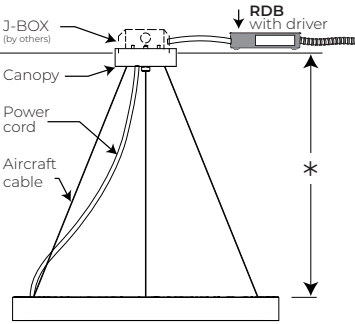

AC - Aircraft cable

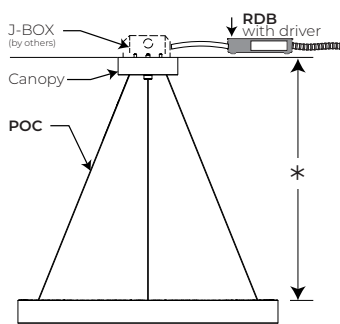

POC - Power-over-aircraft cable

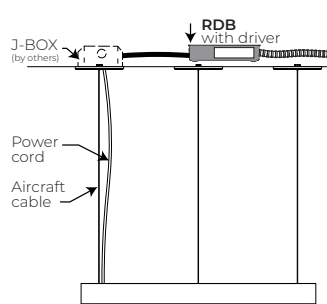

AC - Aircraft cable

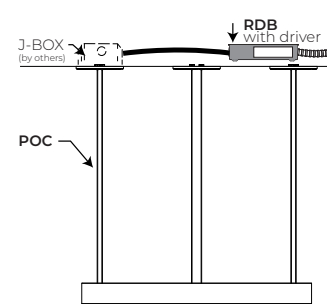

POC - Power-over-aircraft cable

\*minimum height

For single canopy option, the minimum required mounting heights:

#### Fixture size \* Minimum height

Ø 12"	8"
Ø 18"	11"
Ø 24"	15"
Ø 36"	22"
Ø 48"	29"
Ø 60"	36"
Ø 72"	43"

# RIM TUBE ROUND

PENDANT  
STATIC WHITE



## Technical Specifications

### OPTIC

#### Uniform Lambertian Optic (ULO)

Thermoformed from impact-modified white PMMA, the ULO provides even luminosity, with up to 88% transmission. Combined with the LED array running around the inside of the housing, the open form and ULO create a widespread 50% direct and 50% indirect light distribution with spacing criteria of 1.6.

### LIGHT SOURCE

Custom array of mid-flux LEDs are mounted directly to the housing for optimal thermal performance. Available in 2700K, 3000K, 3500K and 4000K with 90+ CRI and elevated R9 value. Color consistency is maintained to 3 SDCM.

All LEDs have been tested in accordance with IESNA LM-80-08 and results have shown L80 lumen maintenance are greater than 60,000 hours. Absolute product photometry is measured and presented in accordance with IESNA LM-79, unless otherwise indicated.

### ELECTRICAL

Factory-set, adjustable output current LED driver with universal (120-277VAC) input. Dimmable from 100% to 1% with 0-10V dimming control. Rated life (90% survivorship) of 50,000 hours at 50°C max. ambient (and 70°C max. case) temperature. At maximum driver load: Efficiency > 84%, PF > 0.9, THD < 20%. Other specifiable options include Lutron Hi-Lume 1% Eco, eldoLED 1% ECOdrive 0-10V, eldoLED 0.1% SOLOdrive 0-10V, and DALI protocol drivers. All of our standard 0-10V drivers are NEMA 410 compliant.

### PoE

Depending on the PoE manufacturer selected, Lumenwerx will install the node in factory as either integral to the luminaire or as a remote module. Factory programming of the PoE node may or may not enable the following functionalities: lumen package, DUO (tunable white), QUADRO (RGBW), emergency battery backup, and sensor integration. These must be addressed and evaluated on a case-by-case basis.

### FINISH

**Interior:** 95% reflective, matte white powder coating

**Exterior:** Matte white, matte black or aluminum powder coating. Custom finishes are also available.

### CONSTRUCTION

**Housing:** Rolled and seamlessly welded aluminum

**Lens:** Coextruded polycarbonate

### WEIGHT

Ø 12": 2.3 lbs - 1 kg

Ø 18": 3.5 lbs - 1.6 kg

Ø 24": 4.7 lbs - 2.1 kg

Ø 36": 7.1 lbs - 3.2 kg

Ø 48": 9.4 lbs - 4.3 kg

Ø 60": 11.8 lbs - 5.3 kg

Ø 72": 14.1 lbs - 6.4 kg

### CERTIFICATION

**ETL:** Rated for indoor dry/damp locations. Conforms to UL Standard 1598 and certified to CAN/CSA Standard C22.2 No. 250.0.

### WARRANTY

Lumenwerx provides a five-year limited warranty on electrical and mechanical performance of the luminaires, including the LED boards, drivers, and auxiliary electronics. Lumenwerx will repair or replace defective luminaires or components at our discretion, provided they have been installed and operated in accordance with our specifications. Other limitations apply, please refer to the full warranty on our website.