



FORMA - TOTE

Pendant - Direct and Direct / Indirect

LUMENWERX

 This product must be installed in accordance with the National Electrical Code and all applicable local codes, by a person familiar with the construction and operation of the product, and the hazards involved. Proper grounding is required for safety.

Ce produit doit être installé suivant le code national de l'électricité, ainsi que tous les codes locaux applicables, par une personne familière avec la construction et le fonctionnement du produit, ainsi que tous les risques qui y sont associés. La mise à terre électrique est obligatoire pour la sécurité.

 Wire dimming conductors as Class 1.

 Shown with Tote 12 IN.

AC (Aircraft cable)

1 SEPARATE CANOPY.

Loosen the decorative nut [A] on the canopy [B]. Separate the canopy [B] and cable holder plate [C] from the cross bar [D].

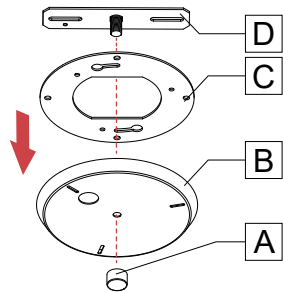

2 PASS AIRCRAFT CABLES.

Pass the aircraft cables [E] through the cable holder plate [C] and the canopy [B].

Insert all aircraft cables [E] into the griplocks [F].

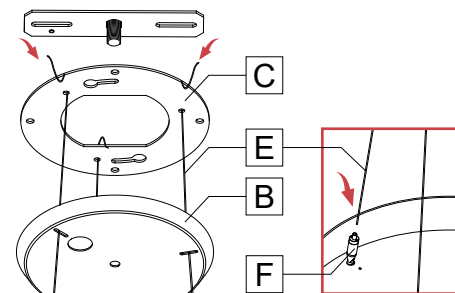

3 MAKE ELECTRICAL CONNECTIONS.

Install the cross bar [D] and the cable holder plate [C] to the J-box.

Make a knot in the power cord [G], and then make the electrical connections between the power cord [G] and the main power [H] with the wire nuts [I].

Warning: A luminaire with more than one power supply connection means shall be connected to only one branch circuit.

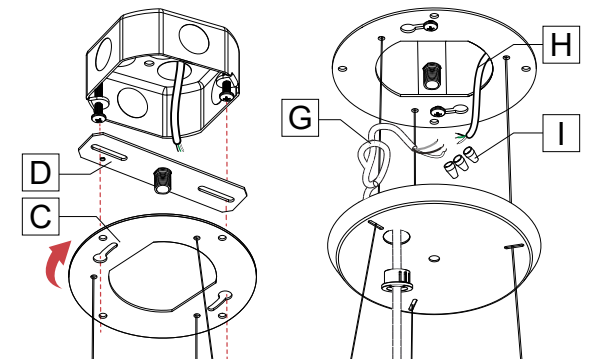

4 REINSTALL CANOPY.

Put the canopy [B] back in place and fix using the decorative nut [A].

Secure the power cord [G] to aircraft cable [E] with plastic clip [J].

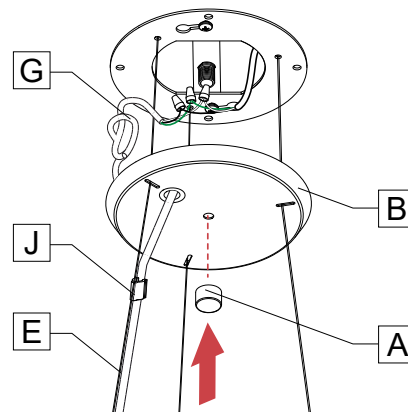

5 ADJUST AIRCRAFT CABLES.

Adjust the cables by pushing the feeder tube.

Cut the excess cables with an aircraft cable cutter [K].

